

KENT COUNTY PLANNING SERVICES

FINISHED BASEMENT WALL SECTION

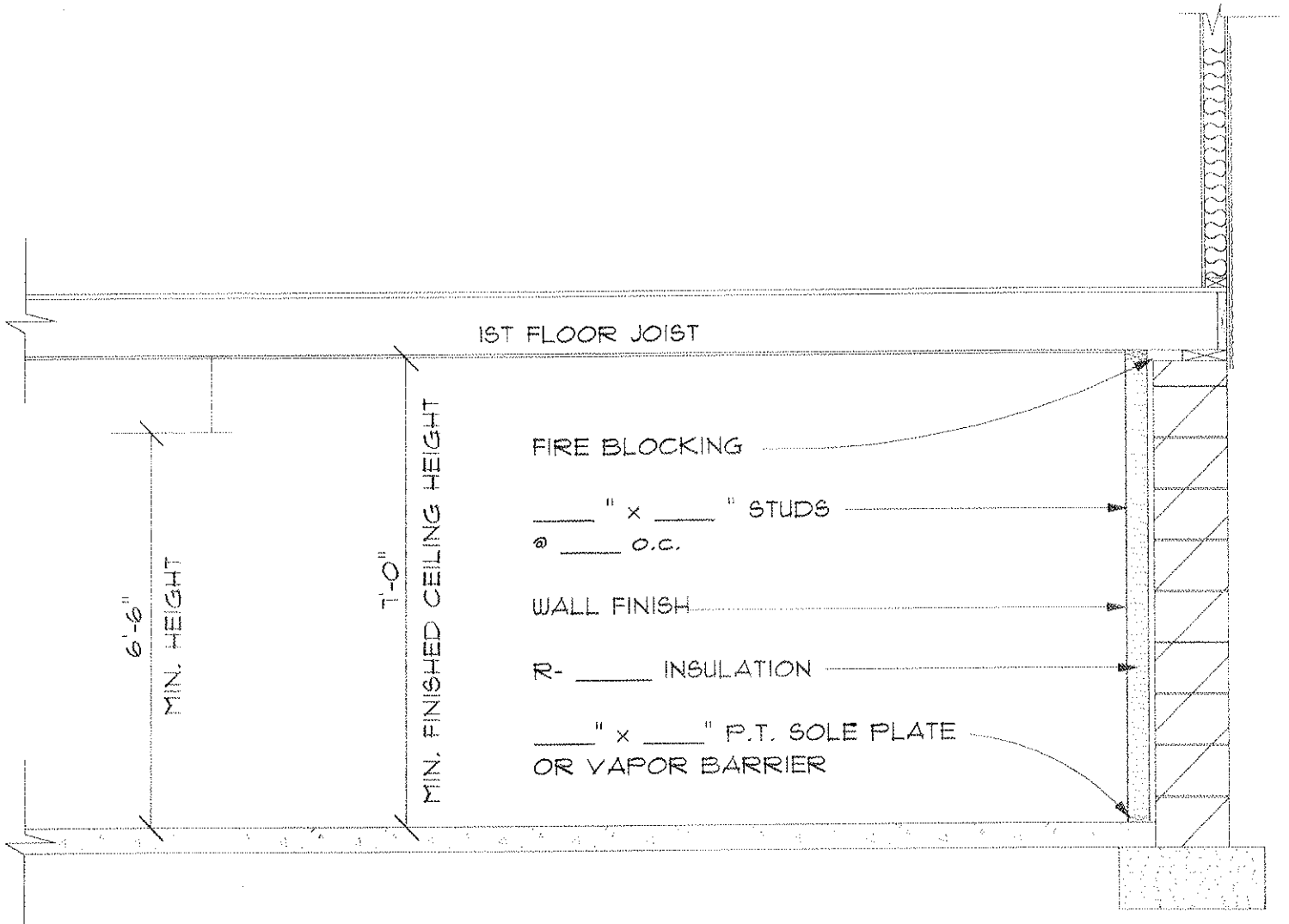

FILL IN ALL APPLCABLE SPACES

Finished ceiling height may not be less than 7'-0".
The required height shall be measured from
the finished floor to the lowest projection from the ceiling.

EXCEPTION:

Beams or girders spaced not less than 4 feet on center
may project not more than 6" below the required ceiling height.

Finished Basement Floor Plan

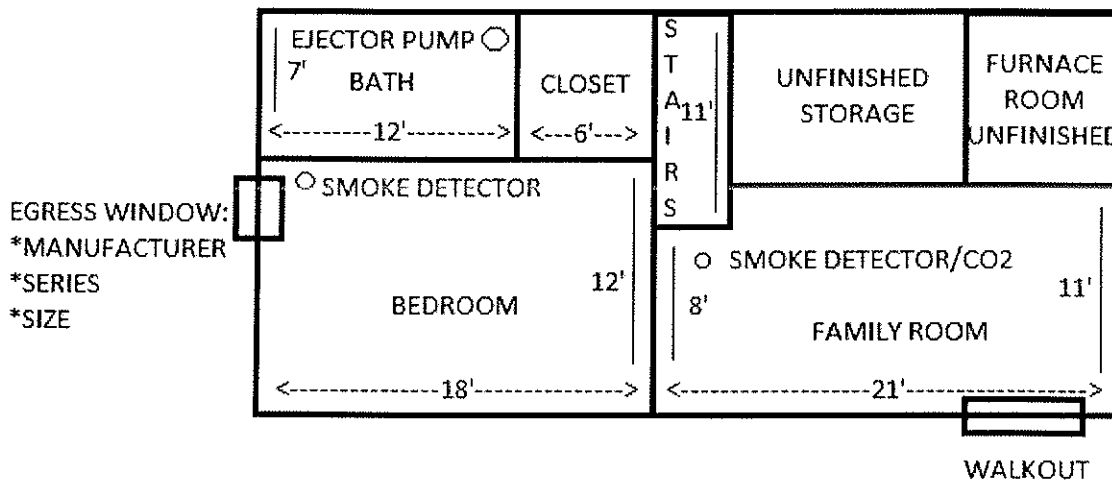

- Must show entire basement including unfinished areas.
- Label dimensions of all rooms to be finished.
- Note the location of a means of egress (window, walkout or bilco door). If there is no means of egress a permit will be required to construct one.
- Note the location of smoke detector.
- Label intended use of spaces to be finished (i.e. bedroom, bathroom, family room).
 - If creating a bedroom:
 - Note the location of a smoke detector inside the bedroom.
 - Note the location of a smoke/carbon monoxide detector outside the bedroom within 10 feet of the bedroom door.
 - Note the location of a means of egress within the bedroom (window, walkout or bilco door).
 - If using an egress window please include manufacturer, series and size of window.
 - If creating a bathroom please note the location of the ejector pump and back flow perimeter.