

Kent County Levy Court

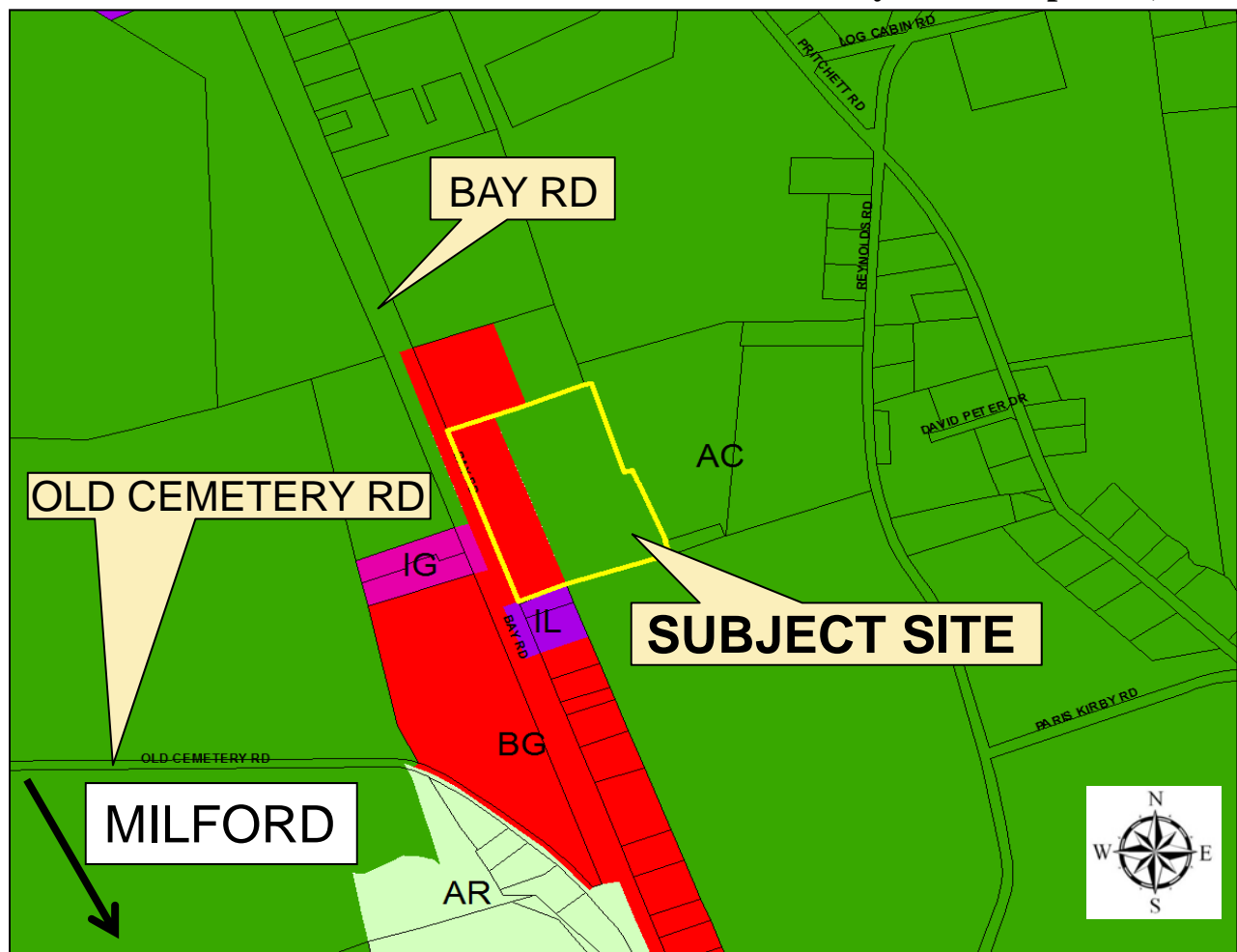

Exhibit A

Application: CZ-20-02
Bay Road Properties, LLC



LOCATION AND ZONING MAP

APPLICANT/OWNER: Bay Road Properties, LLC Attn: Brian Shirey
PRESENT COMPREHENSIVE PLAN MAP DESIGNATION: Low Density Residential & Highway Commercial
PROPOSED COMPREHENSIVE DESIGNATION: Highway Commercial
PRESENT ZONING DISTRICT: AC (Agricultural Conservation) & BG (General Business)
PROPOSED ZONING DISTRICT: BG (General Business)
LEVY COURT DISTRICT: 4th
PRESENT USE: Used Car Sales
TAX MAP NO: MD-00-152.00-01-37.03-000
LOCATION: 19.92 +/- acres located on the east side of Bay Rd, approx. 2,550' north of Spring Hill Dr and approx. 5,738' south of Old Milford Neck Rd, north of Milford