

Kent County Levy Court

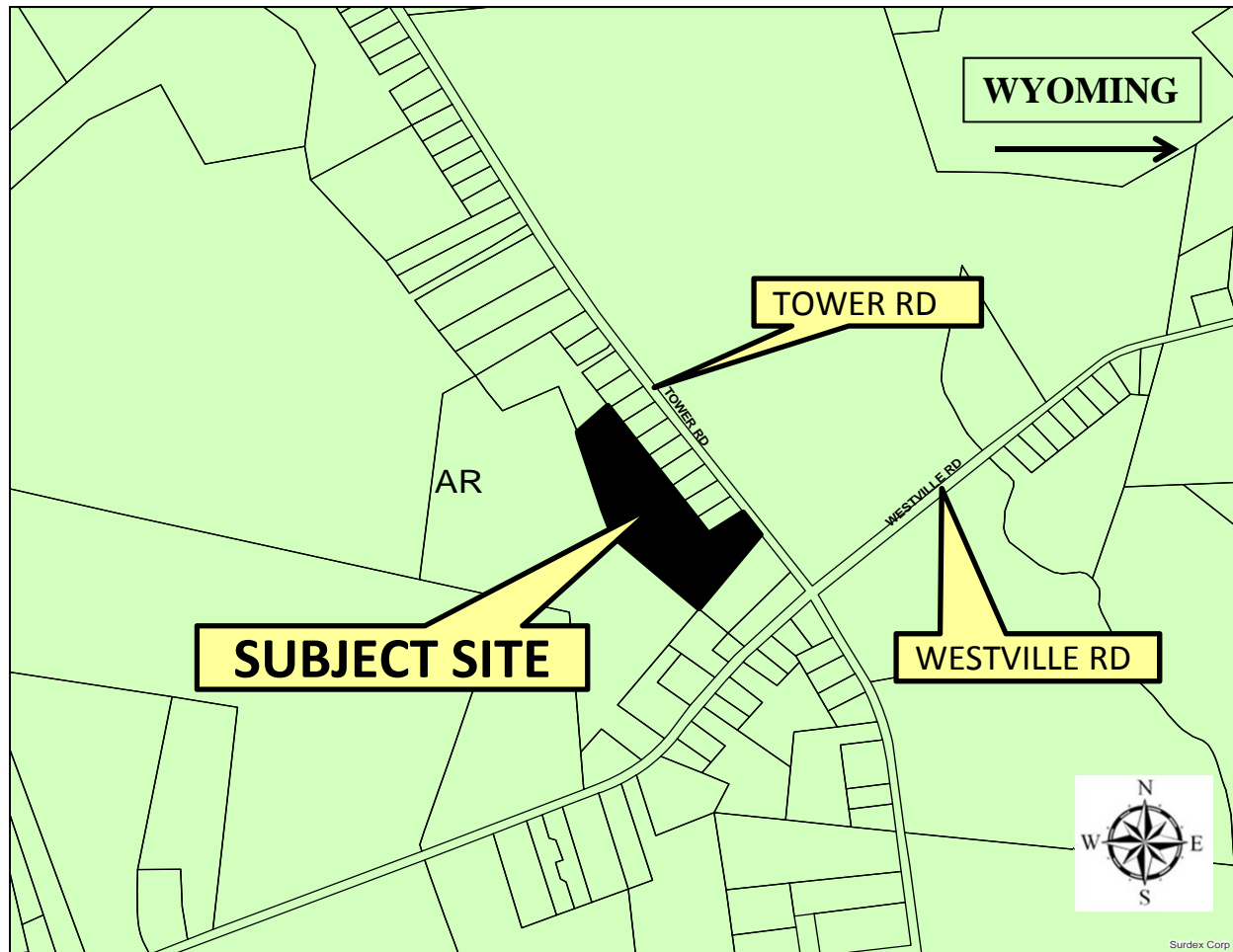

Exhibit A

Application: C-20-07
Miller



LOCATION AND ZONING MAP

APPLICANT/OWNER: Raymond W. & Lisa Mae Miller

PRESENT ZONING DISTRICT: AR (Agricultural Residential)

PRESENT USE: Residential

PROPOSED USE: Same with farm machinery/equipment repair and service

LEVY COURT DISTRICT: 6th

TAX MAP NO: WD-00-091.00-01-27.21-000

LOCATION: 9.5+/- acres located on the west side of Tower Rd. (Co. Rd. 218), 426' from Westville Rd. (Co. Rd. 52), west of Wyoming