

Kent County Levy Court

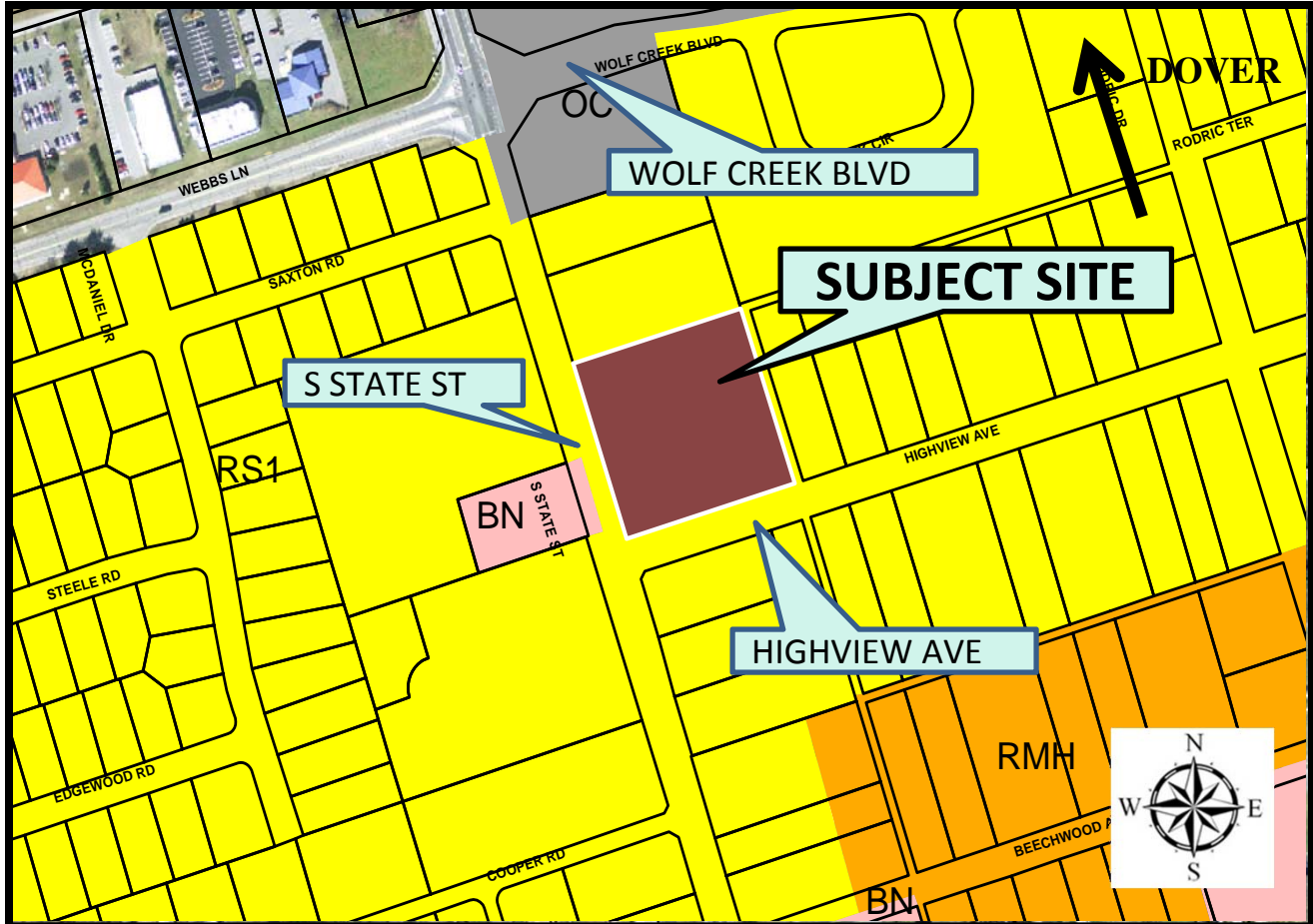

Exhibit A

Application: CS-19-05
Redeemed Christian Church of God Father's House Assembly



LOCATION AND ZONING MAP

APPLICANT: Vincent Ikwuagwu

OWNER: Redeemed Christian Church of God Father's House Assembly

ENGINEER: Mountain Consulting, Inc. c/o Troy L. Adams P.E.

PRESENT ZONING DISTRICT: RS1 (Single Family Residential)

LEVY COURT DISTRICT: 2nd

TAX MAP NO: ED-00-086.09-01-76.00-000

PRESENT USE: Residential

PROPOSED USE: Church

LOCATION: 2.0+/- acres located on the northeast corner of S. State St. (US Rt. 113A)
and Highview Ave. (Co. Rd. 354), South of Dover

Exhibit B

Application: CS-19-05
Redeemed Christian Church of God Father's House Assembly

PROPOSED CHURCH

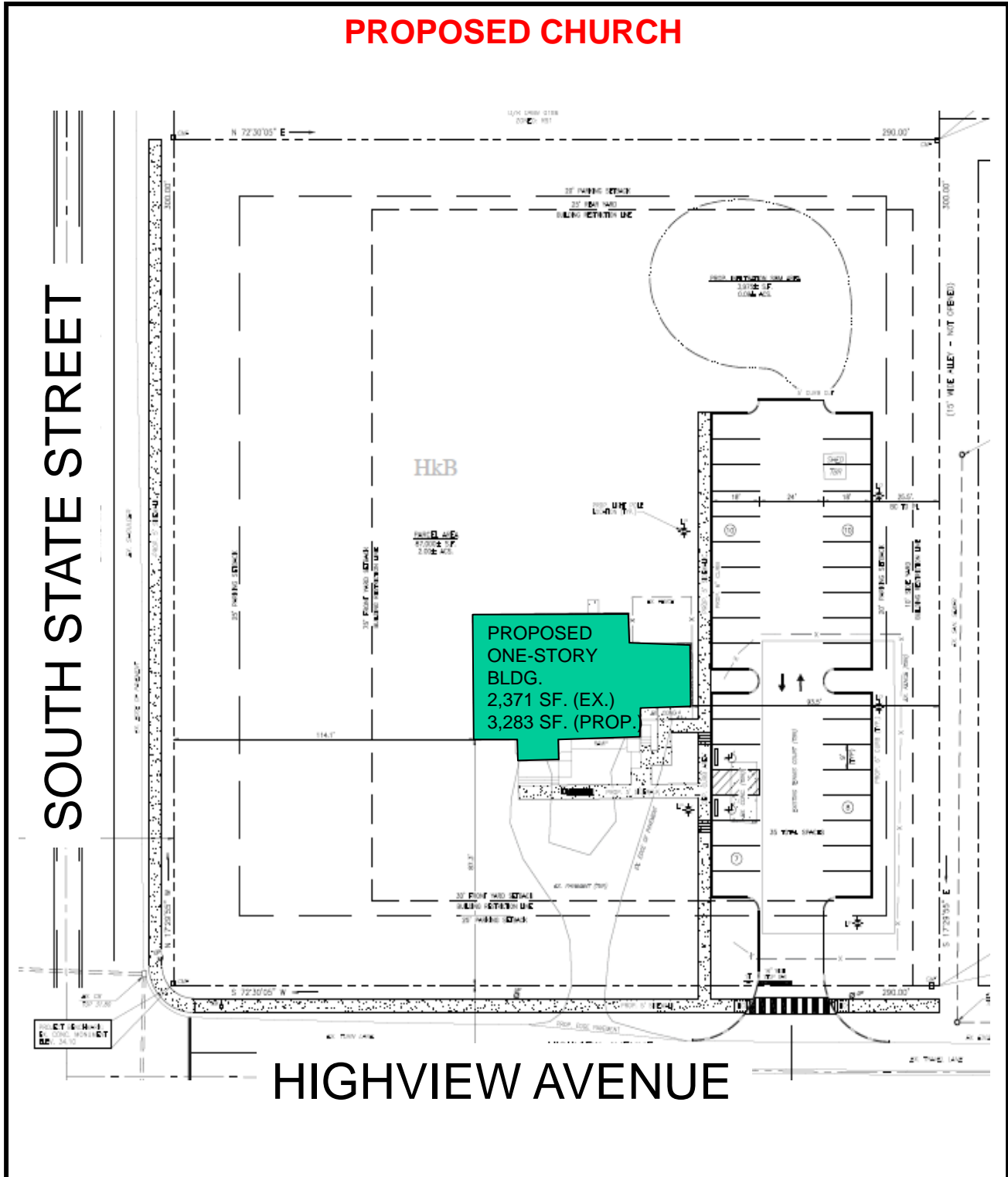

PLOT PLAN (CROPPED)