

Kent County Levy Court

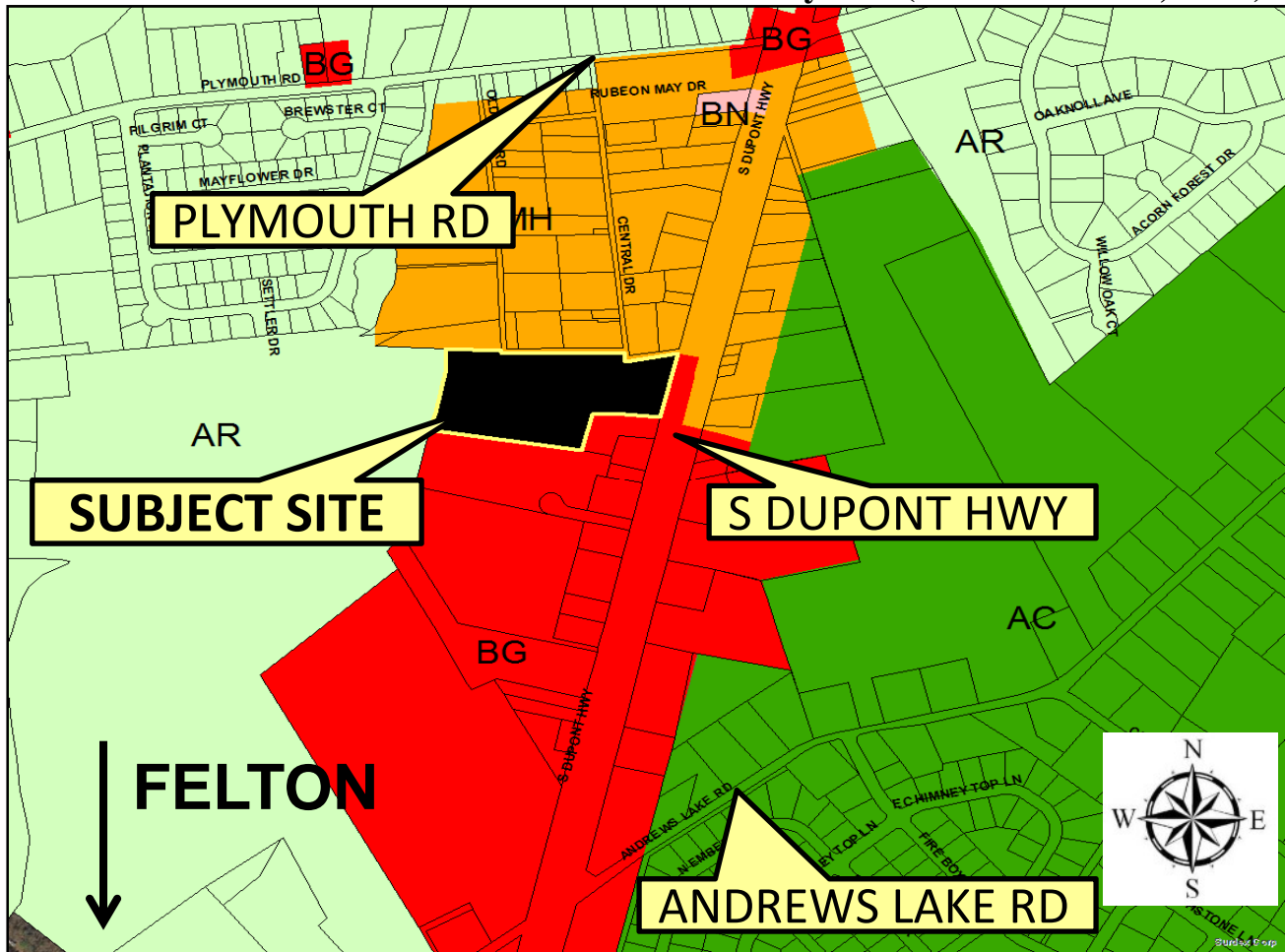

Exhibit A

Application: CS-19-04
Baynum (Rose Industries, LLC)



LOCATION AND ZONING MAP

APPLICANT/OWNER: Shaun Baynum (Rose Industries, LLC)
ENGINEER: Mountain Consulting, Inc. c/o Troy Adams, P.E
PRESENT ZONING DISTRICT: BG (General Business)
LEVY COURT DISTRICT: 6th TAX MAP NO: SM-00-129.01-01-60.00-000
PRESENT USE: Vacant
PROPOSED USE: Contractors Establishment (Maintenance Shop/Yard with Office)
LOCATION: 8.1 +/- acres on the west side of S. Dupont Hwy., approx. 1,518 ft. south of Plymouth Rd. (Co. Rd. 239), north of Felton

Exhibit B

Application: CS-19-04
Baynum (Rose Industries, LLC)

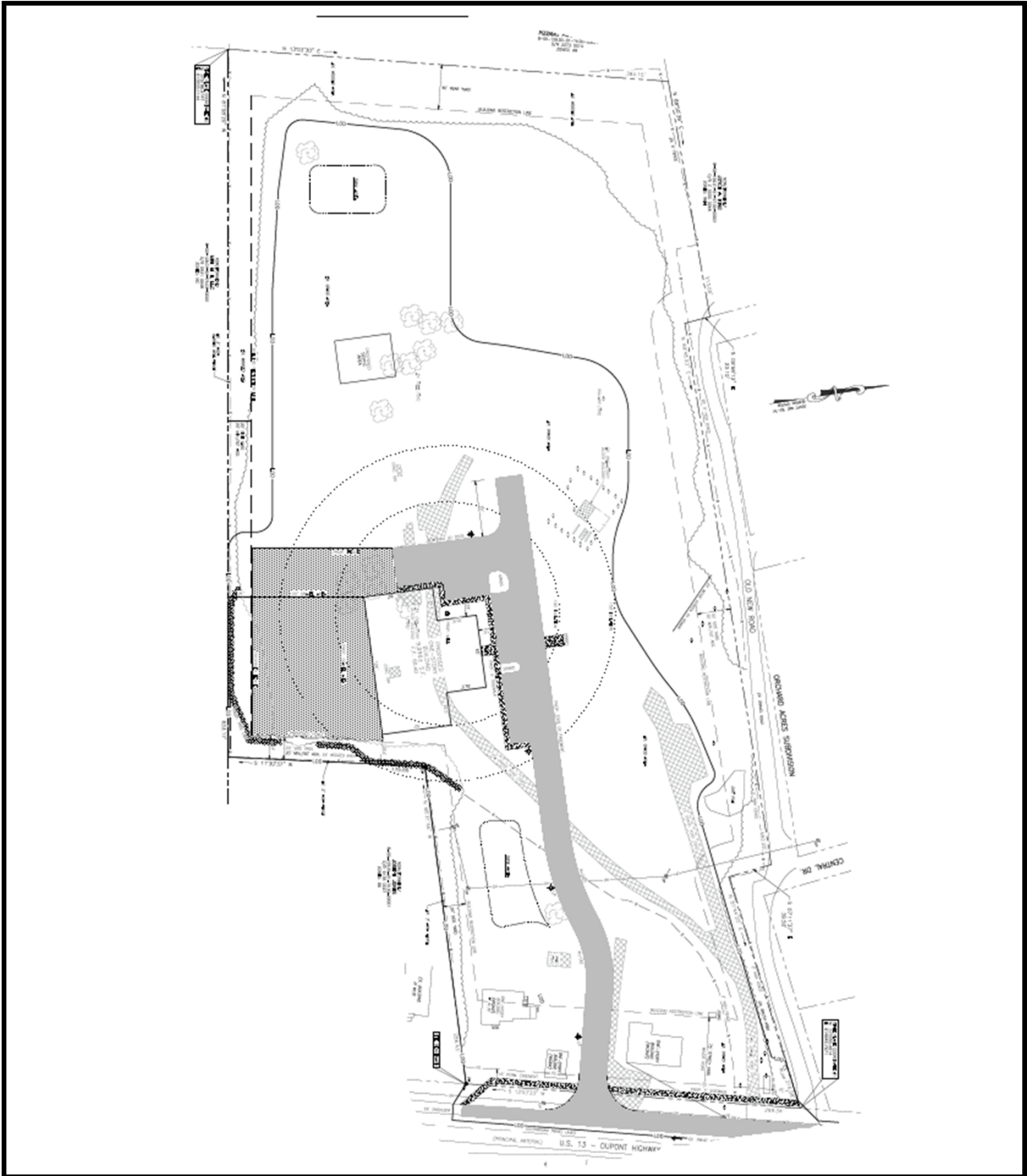

PLOT PLAN