

KENT COUNTY Board of Adjustment

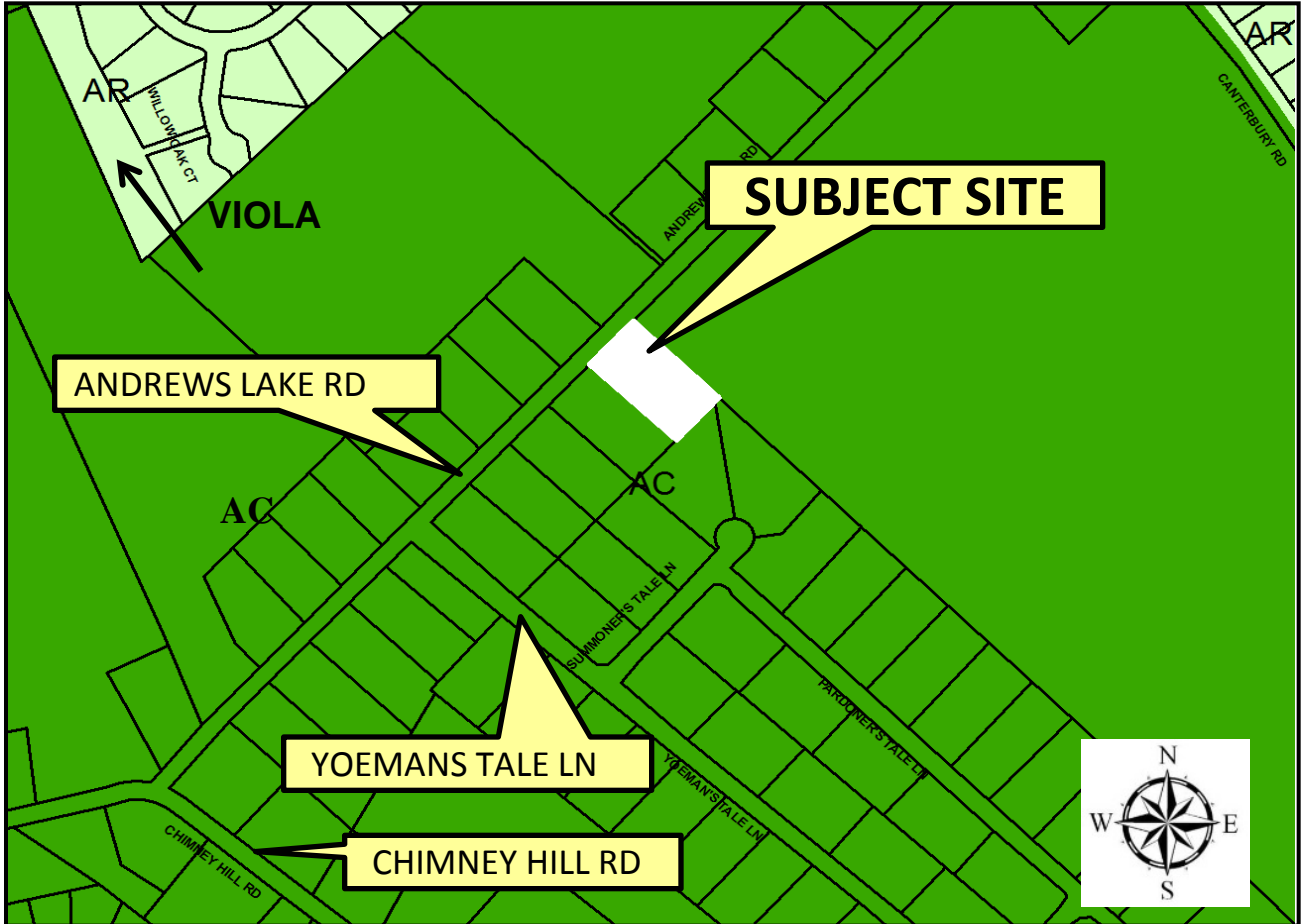

Exhibit A

Application: A-19-03
Thompson (Block)



LOCATION AND ZONING MAP

APPLICANTS: Seth L. Thompson Esq.

OWNERS: Arnold J. & Ceil Block

PRESENT ZONING DISTRICT: AC (Agricultural Conservation)

PROPOSED VARIANCE: Variance from provisions prohibiting the parking of a commercial vehicle on a residential lot to allow the parking of a commercial vehicle

PRESENT USE: Residential

PROPOSED USE: Same, with commercial vehicle parking

LEVY COURT DISTRICT: 6th

TAX MAP NO: SM-00-129.00-02-20.12-000

LOCATION: Located on the southeast side of Andrews Lake Rd. (Co. Rd. 380), approx. 633' northeast of Yoemans Tale Ln., southeast of Viola.