

Kent County Levy Court

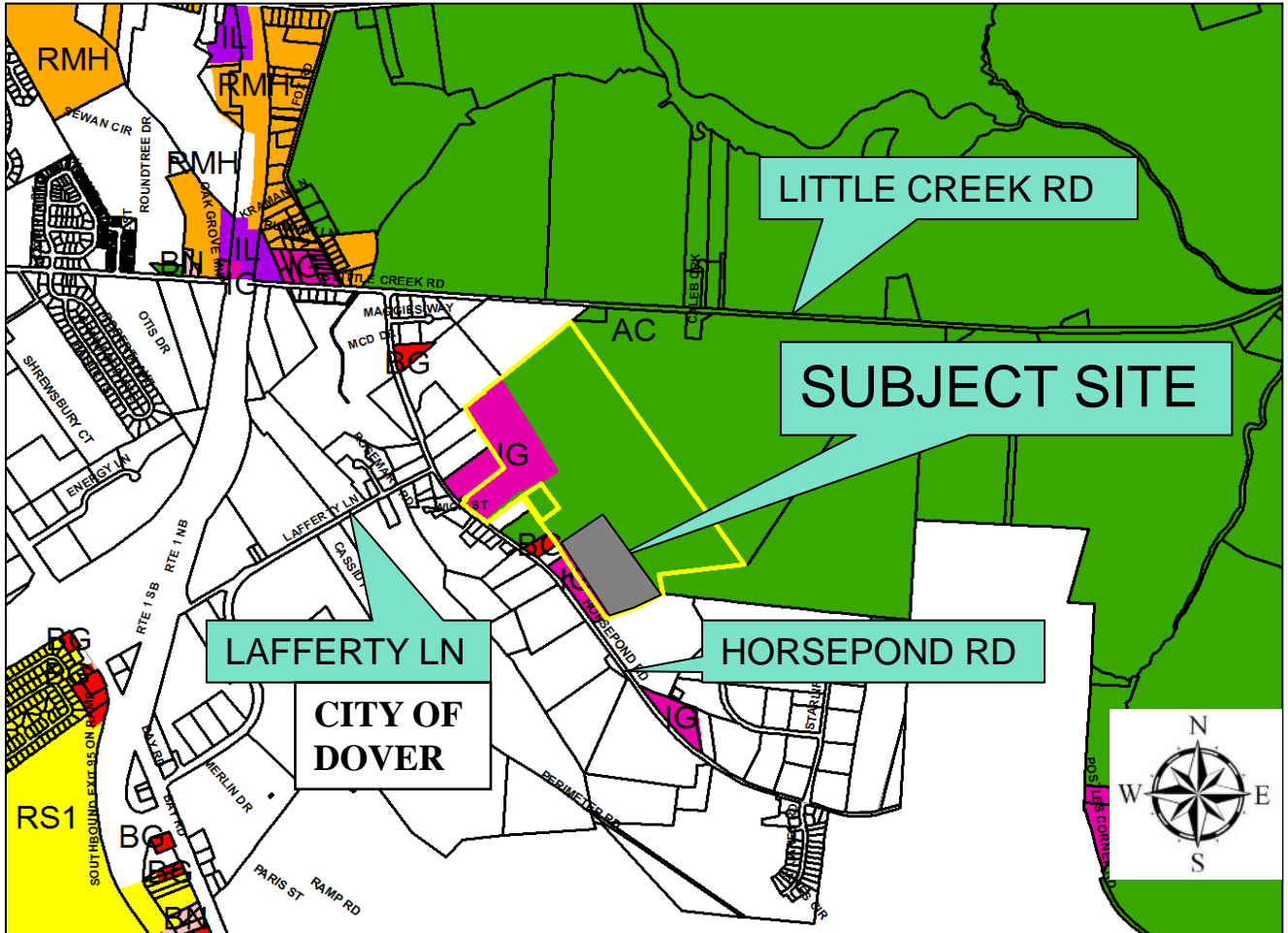

Exhibit A

Application: CZ-18-08
Eastern Woodland Holdings, LLC



LOCATION AND ZONING MAP

APPLICANT/OWNERS: Eastern Woodland Holdings, LLC c/o Chris Coker
ENGINEER: Larson Engineering Group, Inc. Attn: Doug Liberman
PRESENT COMPREHENSIVE PLAN DESIGNATION: Low Density Residential
PROPOSED COMPREHENSIVE DESIGNATION: Industrial
PRESENT ZONING DISTRICT: AC(Agricultural Conservation)
PROPOSED ZONING DISTRICT: IG (General Industrial)
LEVY COURT DISTRICT: 3rd PRESENT USE: Agricultural
TAX MAP NO: ED-00-078.00-01-25.00-000
LOCATION: 125.16 +/- acres (**Area of Petition: 18.322+/- acre**) on the east side of Horsepond Rd., approx. 1,700ft. southeast of Lafferty Ln., adjacent to Dover

Kent County Levy Court



Application: CZ-18-08
Eastern Woodland Holdings, LLC

Exhibit B

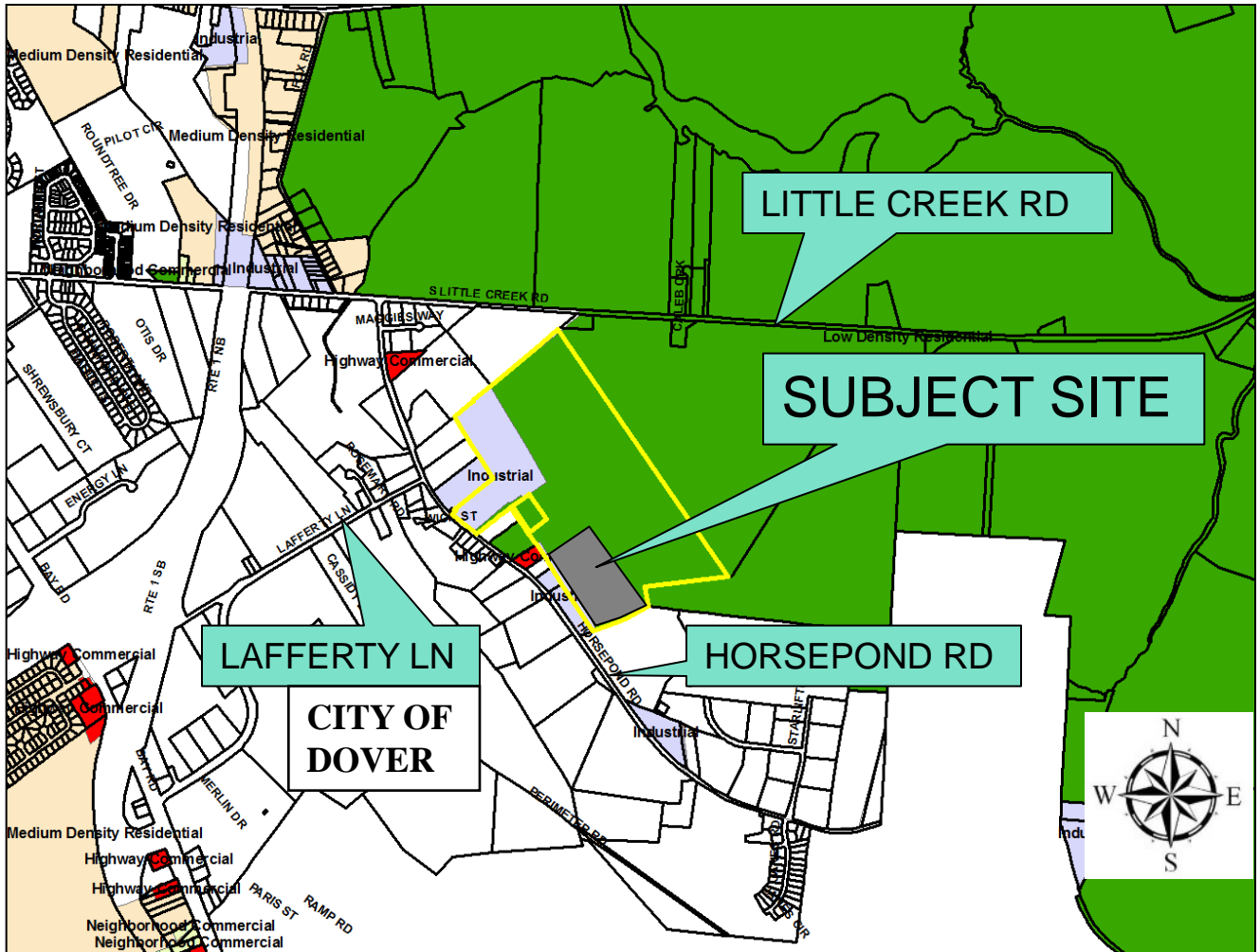

COMPREHENSIVE PLAN MAP

APPLICANT/OWNERS: Eastern Woodland Holdings, LLC c/o Chris Coker
ENGINEER: Larson Engineering Group, Inc. Attn: Doug Liberman
PRESENT COMPREHENSIVE PLAN DESIGNATION: Low Density Residential
PROPOSED COMPREHENSIVE DESIGNATION: Industrial
PRESENT ZONING DISTRICT: AC(Agricultural Conservation)
PROPOSED ZONING DISTRICT: IG (General Industrial)
LEVY COURT DISTRICT: 3rd PRESENT USE: Agricultural
TAX MAP NO: ED-00-078.00-01-25.00-000
LOCATION: 125.16 +/- acres (**Area of Petition: 18.322+/- acre**) on the east side of Horsepond Rd., approx. 1,700ft. southeast of Lafferty Ln., adjacent to Dover

Exhibit C

Application: CZ-18-08
Eastern Woodland Holdings, LLC

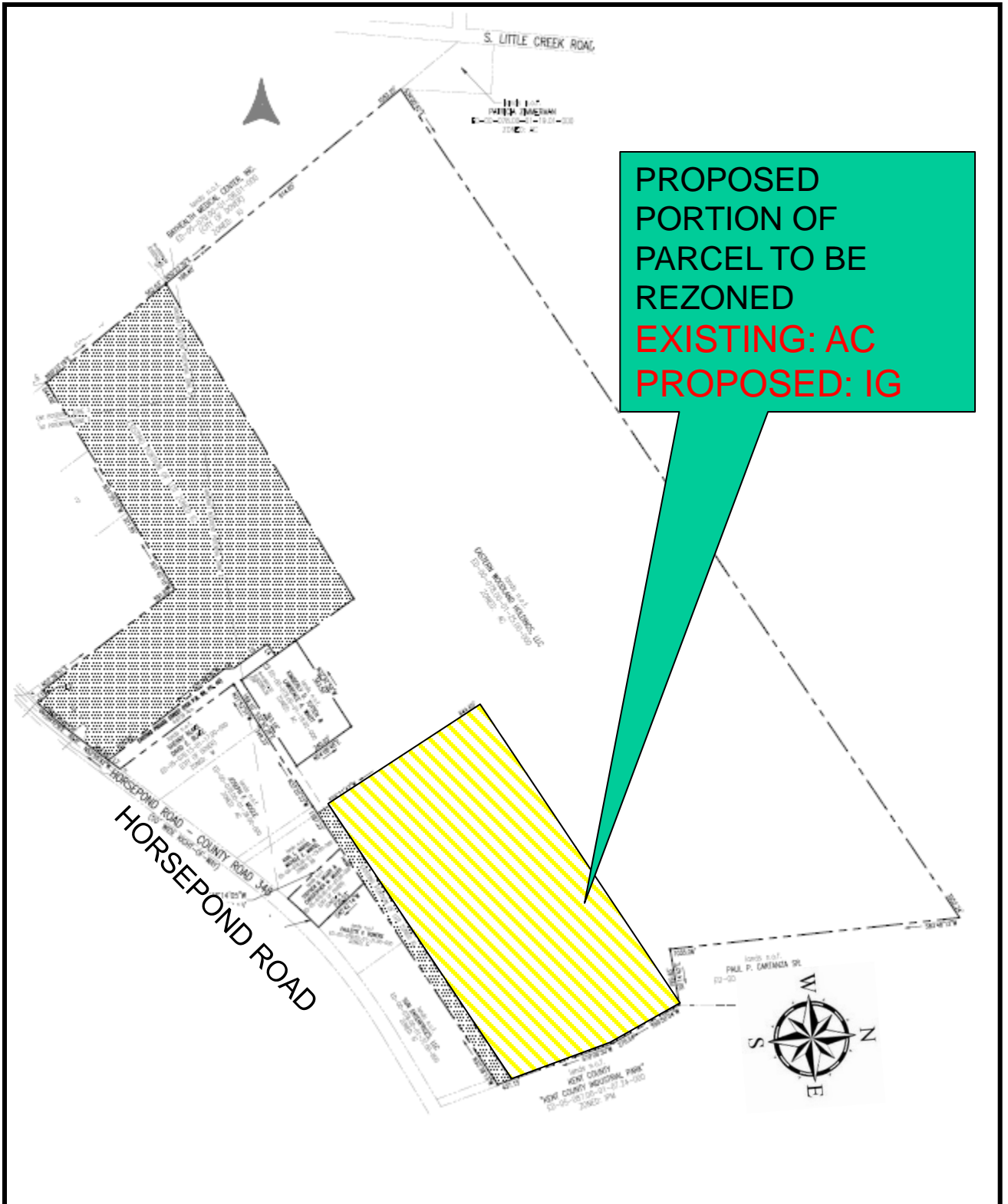

PLOT PLAN

Exhibit D

Application: CZ-18-08
Eastern Woodland Holdings, LLC

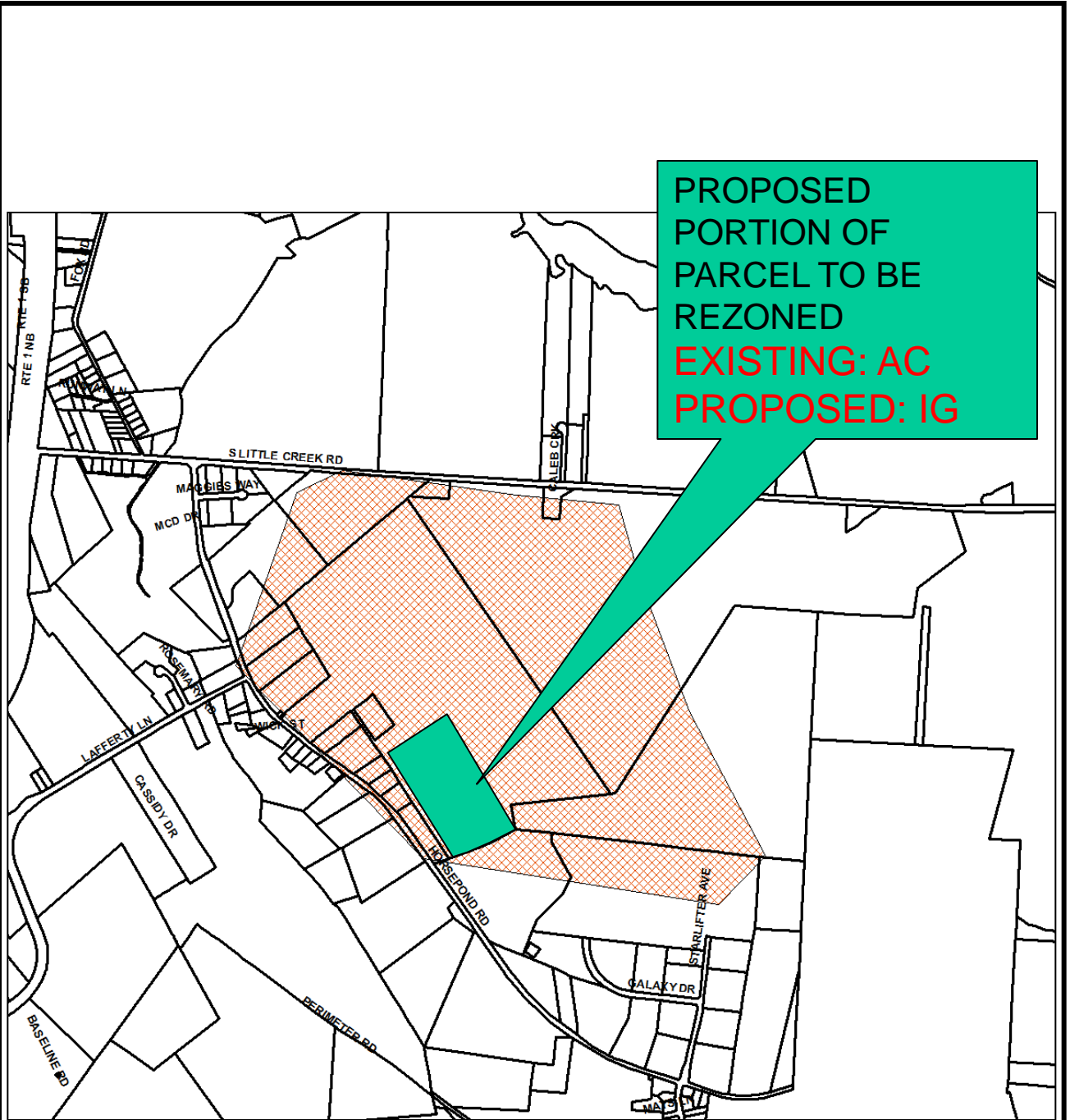

EMPLOYMENT ZONE LAYER

Exhibit E

Application: CZ-18-08
Eastern Woodland Holdings, LLC

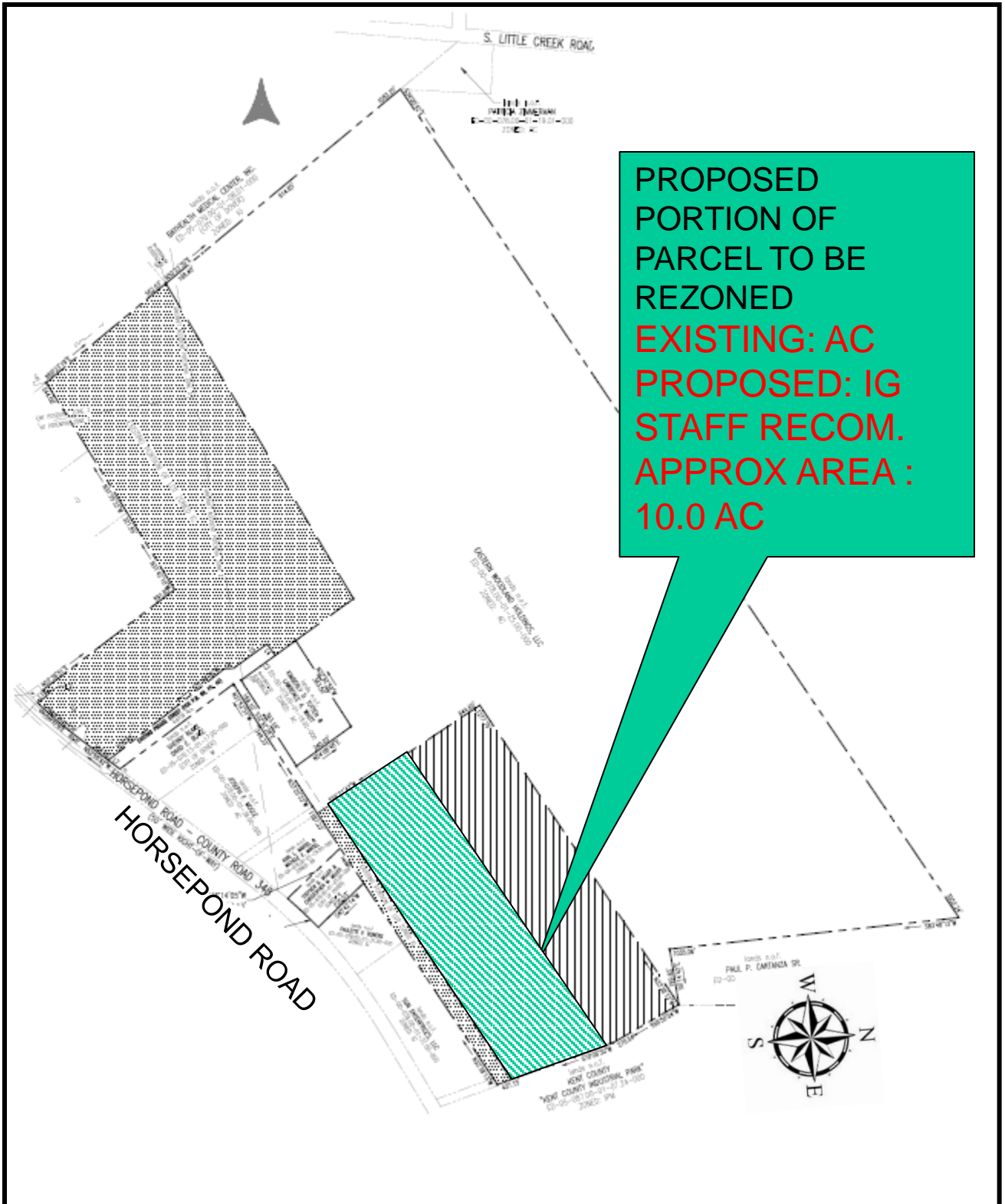

STAFF RECOMMENDATIONS