

# KENT COUNTY Board of Adjustment

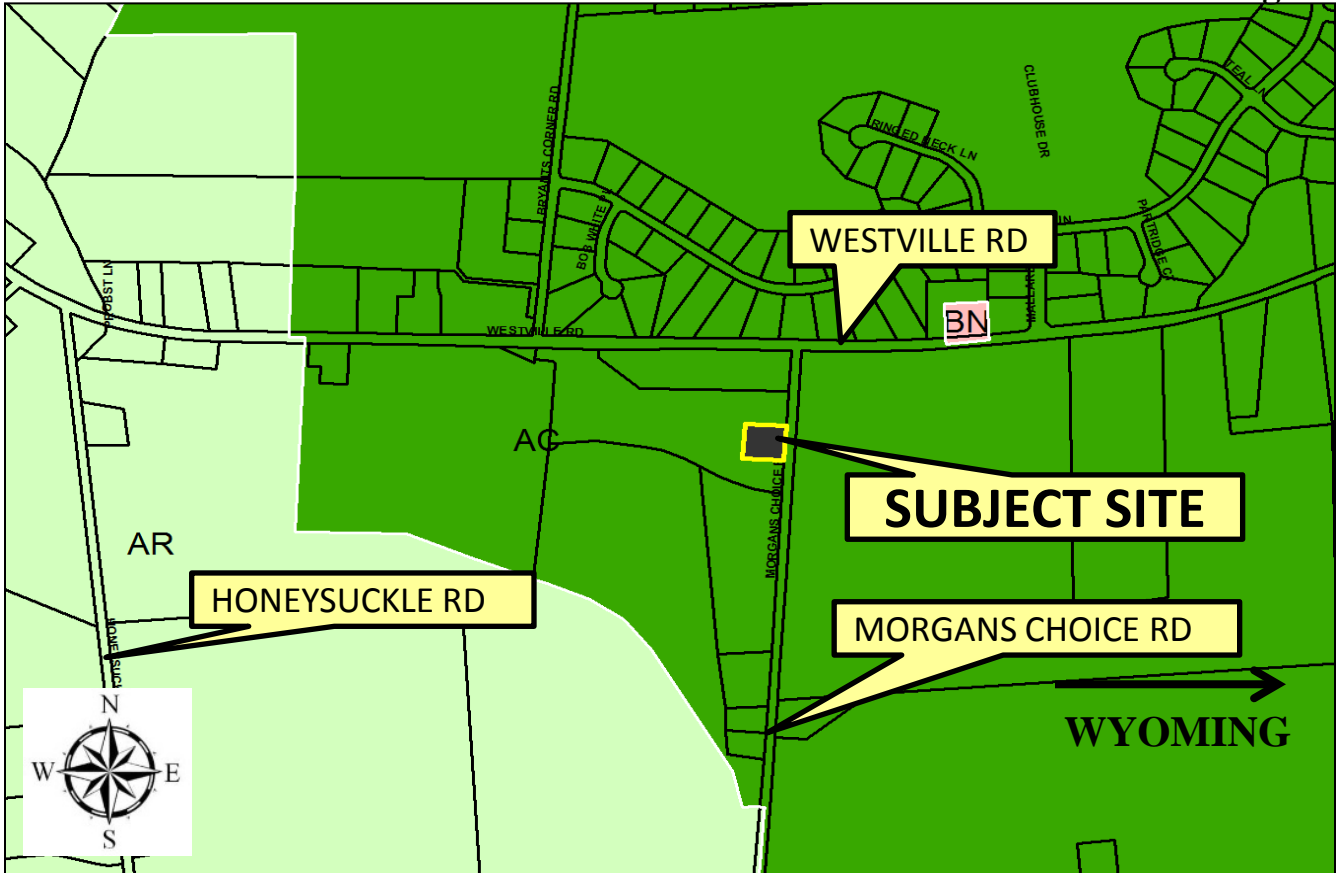

## Exhibit A

Application: A-18-30  
Krokenberger



## LOCATION AND ZONING MAP

APPLICANTS: Rose Krokenberger & Emerson R. Custis aka Rocky Krokenberger

OWNER: Rose Krokenberger

PRESENT ZONING DISTRICT: AC (Agricultural Conservation)

PROPOSED VARIANCE: Variance request from the provision prohibiting accessory structures to dominate in area the principal structure to enable the placement of detached building

PRESENT USE: Residential

PROPOSED USE: same with accessory building

LEVY COURT DISTRICT: 6th

TAX MAP NO: WD-00-092.00-02-19.02-000

LOCATION: Located on the west side of Morgans Choice Rd. (Co. Rd. 230), approx. 440 ft. south of Westville Rd. (Co. Rd. 52), west of Wyoming

# Exhibit B

Application: A-18-30

Krokenberger

Variance from the provision prohibiting accessory structures to dominate in area the principal structure to enable the placement of detached building

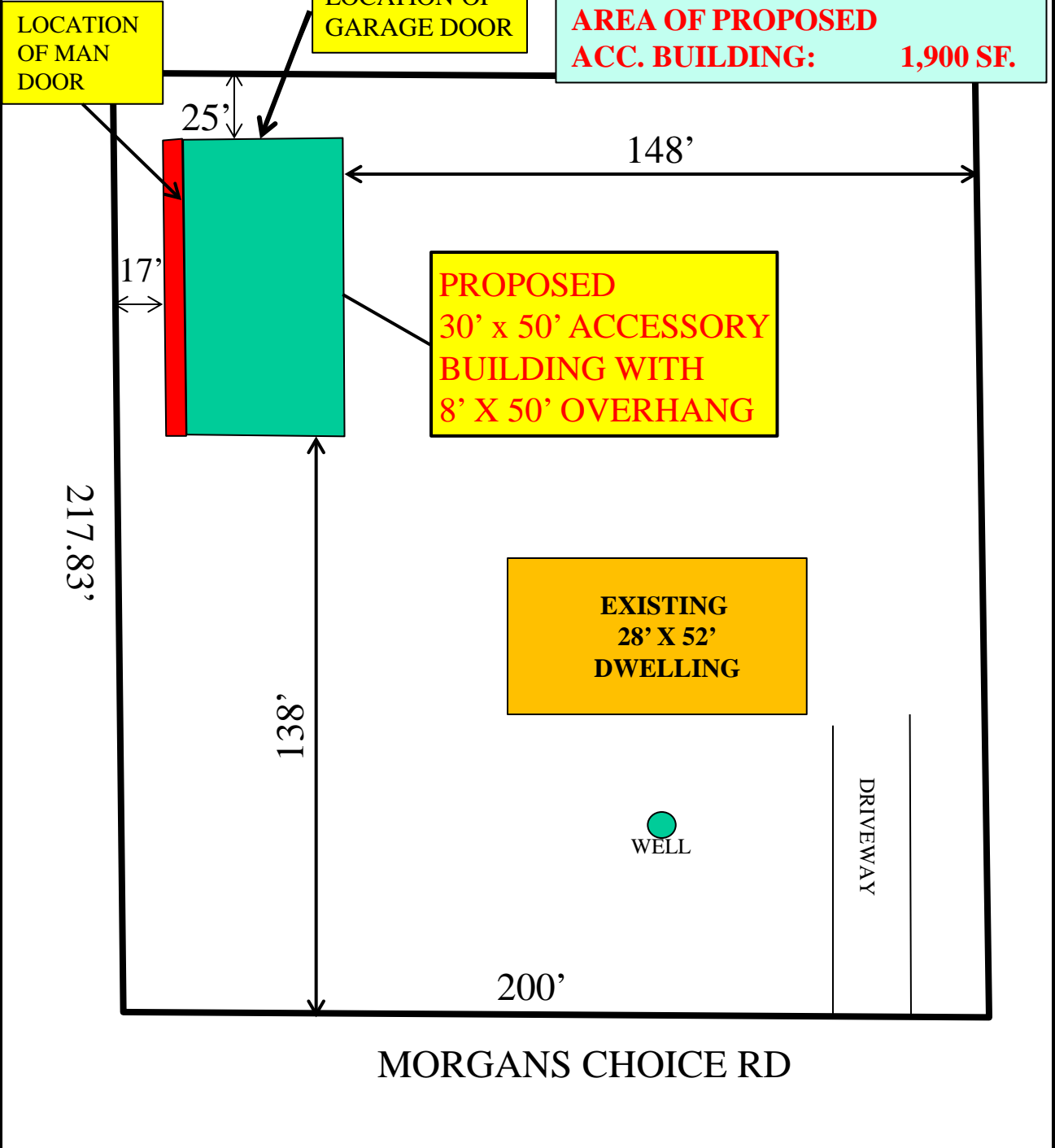

# PLOT PLAN