

KENT COUNTY Board of Adjustment

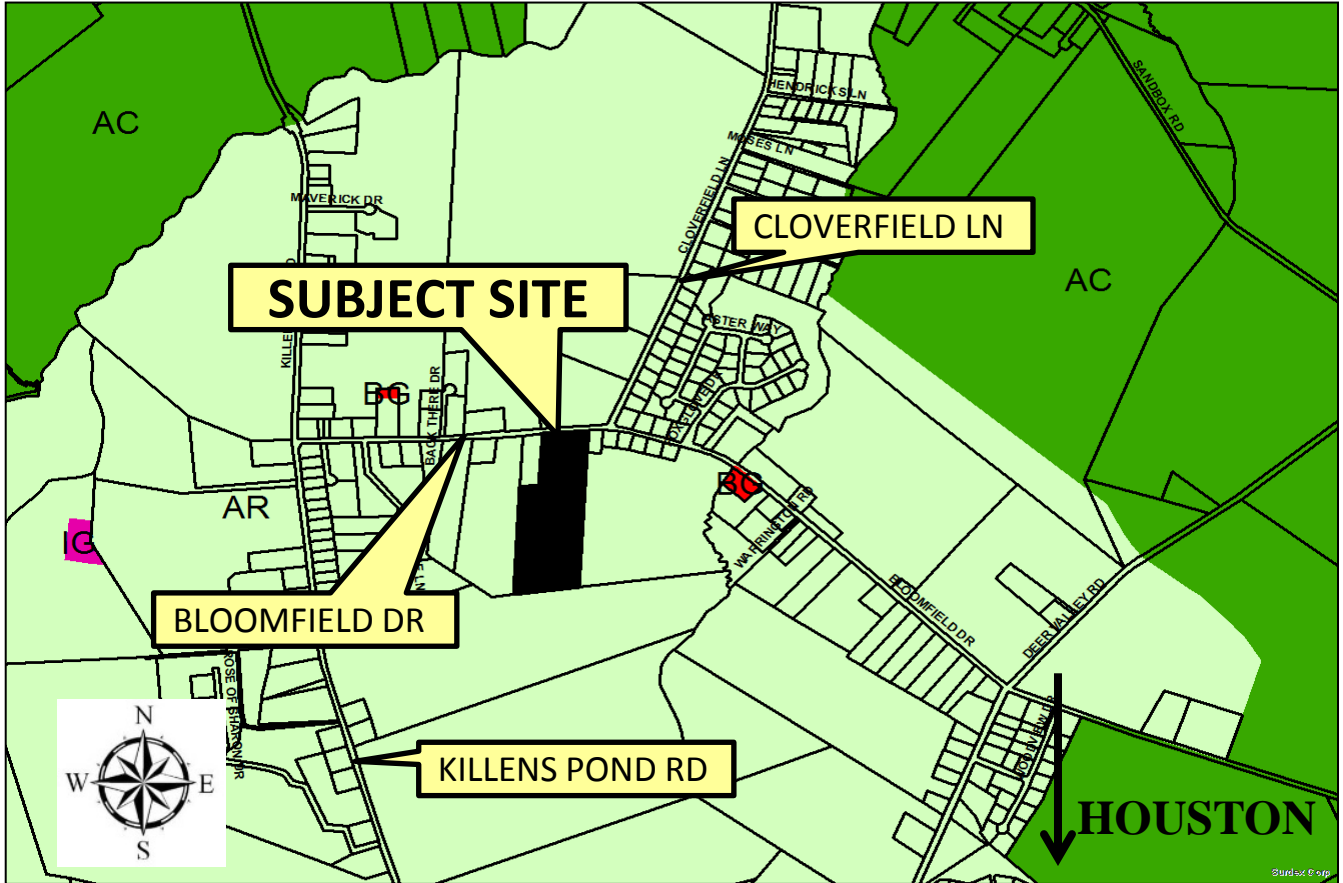

Exhibit A

Application: A-18-24
Dickerson



LOCATION AND ZONING MAP

APPLICANTS/OWNER: Daniel Killen Dickerson

PRESENT ZONING DISTRICT: AR (Agricultural Residential)

PROPOSED VARIANCE: Variance from the minimum frontage requirement of 200' to allow the submittal of a minor subdivision

PRESENT USE: Residential

PROPOSED USE: same with minor subdivision

LEVY COURT DISTRICT: 4th

TAX MAP NO: MD-00-172.00-01-27.00-000

LOCATION: located on the south side of Bloomfield Rd. (Co. Rd. 311), approx. 170ft. west of Cloverfield Ln. (Co. Rd. 397), north of Houston.