

KENT COUNTY Board of Adjustment

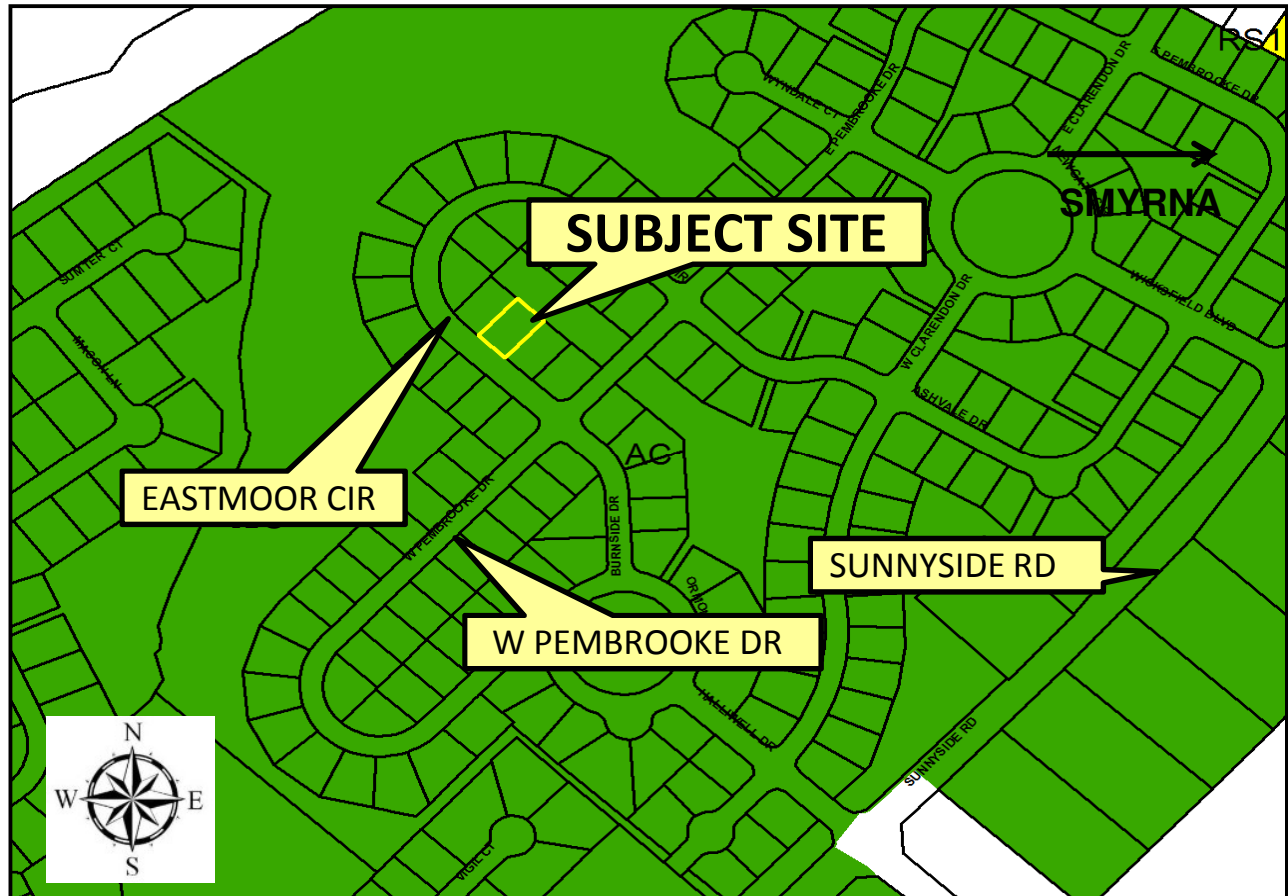

Exhibit A

Application: A-18-09
Baker



LOCATION AND ZONING MAP

APPLICANTS: Brian & Kim Baker

OWNERS: Brian & Kim Baker

PRESENT ZONING DISTRICT: AC (Agricultural Conservation)

PROPOSED VARIANCE: Variance from the maximum impervious surface coverage of 35% to enable the construction of a porch over an existing deck

PRESENT USE: Residential

PROPOSED USE: Same, with porch

LEVY COURT DISTRICT: 1st

TAX MAP NO: DC-00-018.04-02-33.00-000

LOCATION: Located on the northeast side of Eastmoor Cir., approx. 188 ft. northwest of W. Pembroke Dr., being lot 126 of Wicksfield subdivision, west of Smyrna