

# Kent County Levy Court

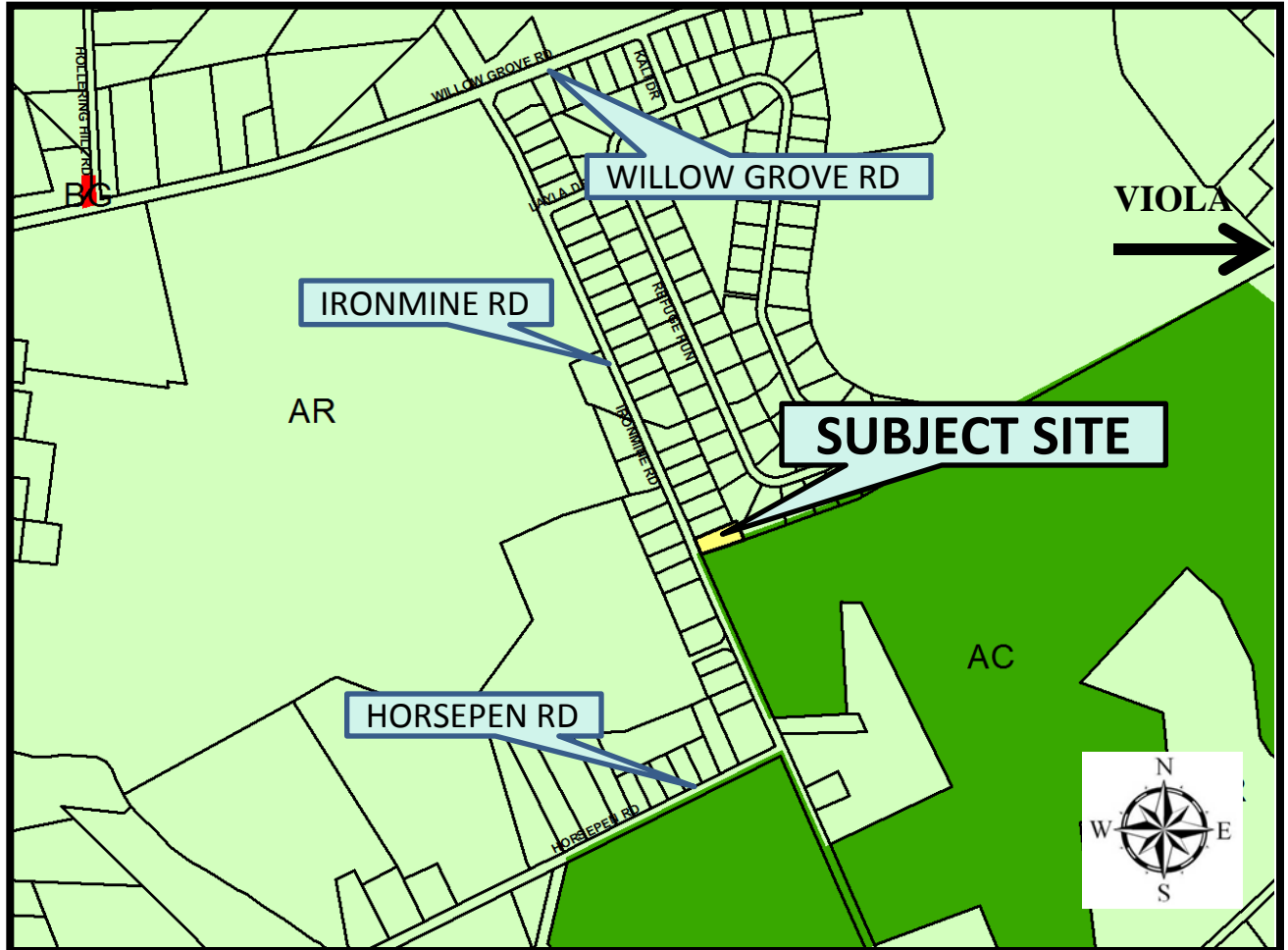

## Exhibit A

Application: CS-18-01  
Tidewater Utilities



## LOCATION AND ZONING MAP

APPLICANT: Tidewater Utilities, Inc.

OWNER: Tidewater Utilites, Inc.

ENGINEER: Becker Morgan, Group, Inc. c/o J. Michael Riemann, P.E.

PRESENT ZONING DISTRICT: AR (Agricultural Residential) , AC (Agricultural Conservation)

LEVY COURT DISTRICT: 6<sup>th</sup> TAX MAP NO: SM-00-118.00-01-24.01-000

PRESENT USE: Public Utility (Well house & Storage Tank) PROPOSED USE: Same

LOCATION: 0.51+/- acres on Ironmine Rd. (Co. Rd. 251) approx. 1,114' north of Horsepen Rd., (Co. Rd. 252) and approx. 2,630' south of Willow Grove Rd. (Rte. 10), west of Viola

**PROPOSED WELL HOUSE**

SHR - 251 IRONMINE ROAD

PROPOSED  
WELL HOUSE  
786 S.F.

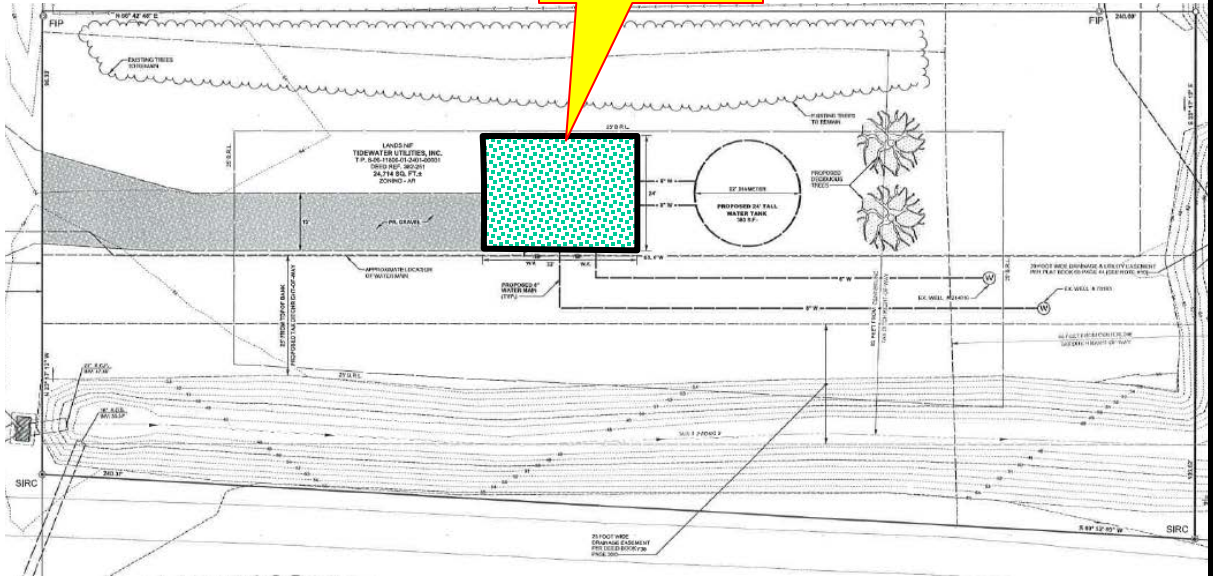

PLOT PLAN (CROPPED)