

Kent County Levy Court

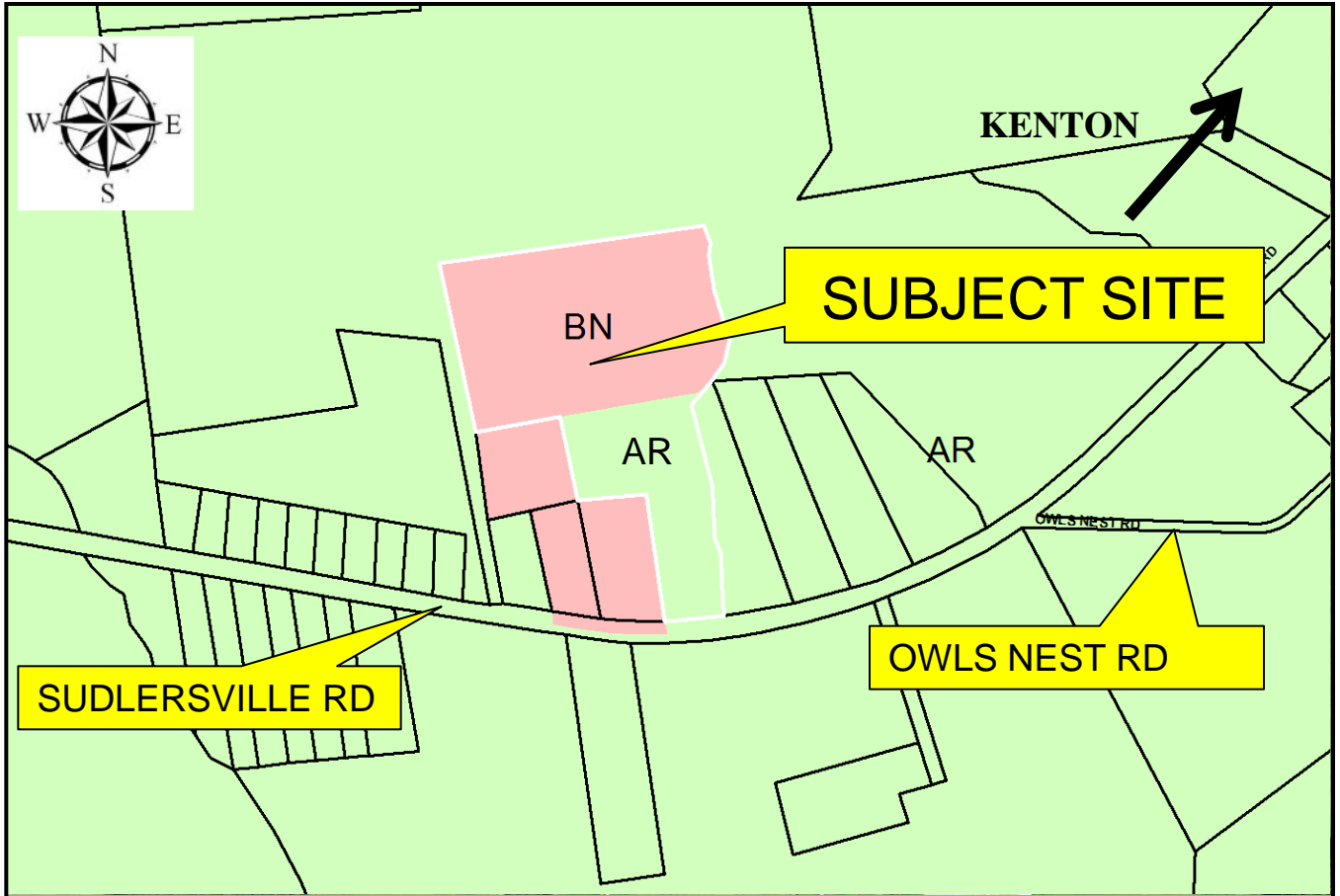

Exhibit A

**Application: CZ-17-13
Cedar Cove RV Resort**



LOCATION AND ZONING MAP

APPLICANT: Cedar Cove RV Resort

OWNERS: Eagle Bldg & Grounds Maintenance

PRESENT COMPREHENSIVE PLAN DESIGNATION: Neighborhood Commercial

PROPOSED COMPREHENSIVE DESIGNATION: Highway Commercial & Low Density Residential

PRESENT ZONING DISTRICT: BN (Neighborhood Business)

PROPOSED ZONING DISTRICT: BG (General Business) & AR (Agricultural Residential)

LEVY COURT DISTRICT: 1st

PRESENT USE: Vacant

TAX MAP NO: KH-00-044.00-01-16.06-000

LOCATION: 16.632+/- acres (Area of Petition: BG 4.567+/- acres & AR 6.411+/- acres) on the north side of Sudlersville Rd. (DE. Rt. 300) approx. 1075' west of Owls Nest Rd. (Co. Rd. 144) southwest of Kenton

Kent County Levy Court



Application: CZ-17-13
Cedar Cove RV Resort

Exhibit B

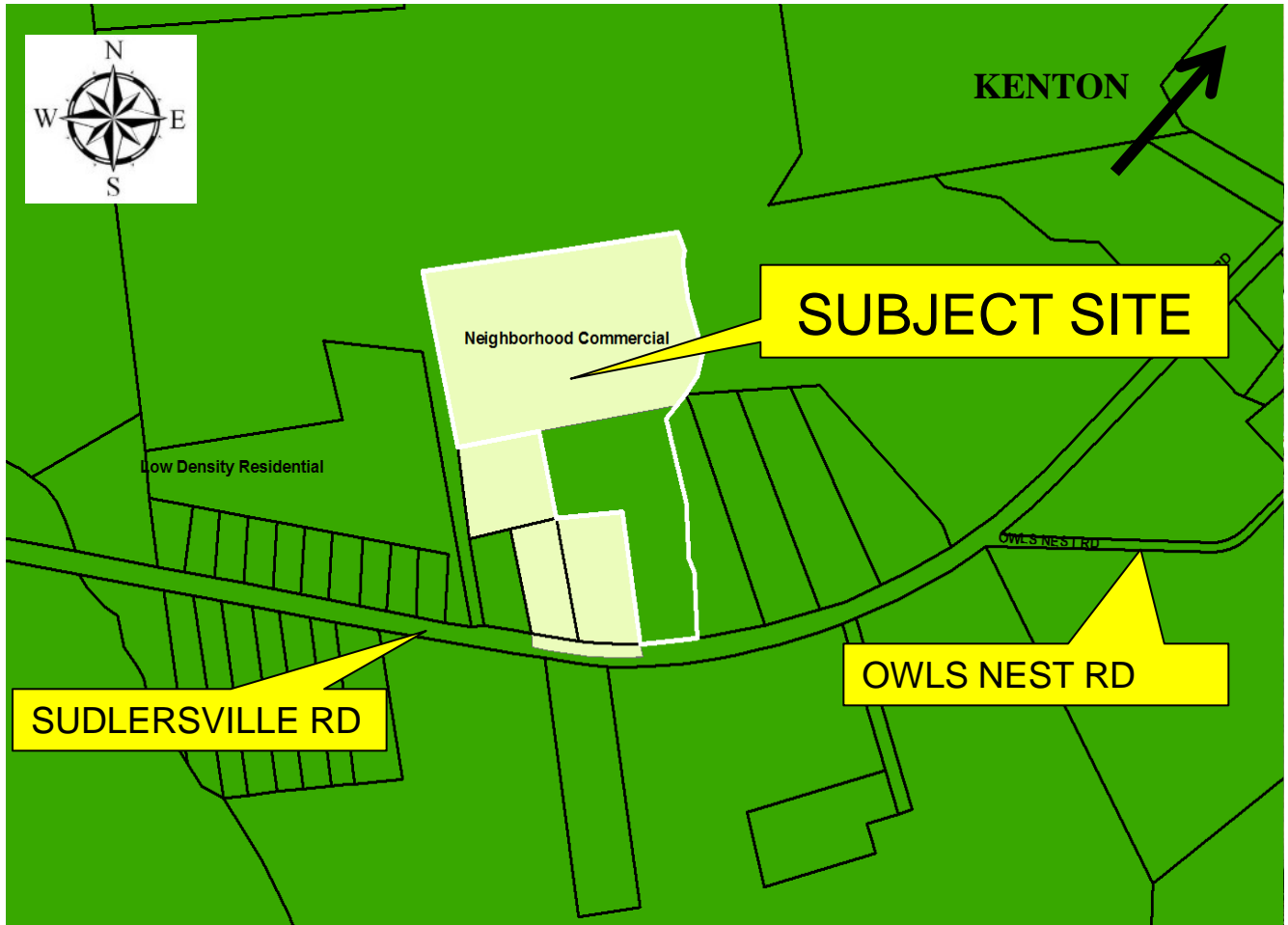

COMPREHENSIVE PLAN

APPLICANT: Cedar Cove RV Resort

OWNERS: Eagle Bldg & Grounds Maintenance

PRESENT COMPREHENSIVE PLAN DESIGNATION: Neighborhood Commercial

PROPOSED COMPREHENSIVE DESIGNATION: Highway Commercial & Low Density Residential

PRESENT ZONING DISTRICT: BN (Neighborhood Business)

PROPOSED ZONING DISTRICT: BG (General Business) & AR (Agricultural Residential)

LEVY COURT DISTRICT: 1st

PRESENT USE: Vacant

TAX MAP NO: KH-00-044.00-01-16.06-000

LOCATION: 16.632+/- acres (Area of Petition: BG 4.567+/- acres & AR 6.411+/- acres) on the north side of Sudlersville Rd. (DE. Rt. 300) approx. 1075' west of Owls Nest Rd. (Co. Rd. 144) southwest of Kenton