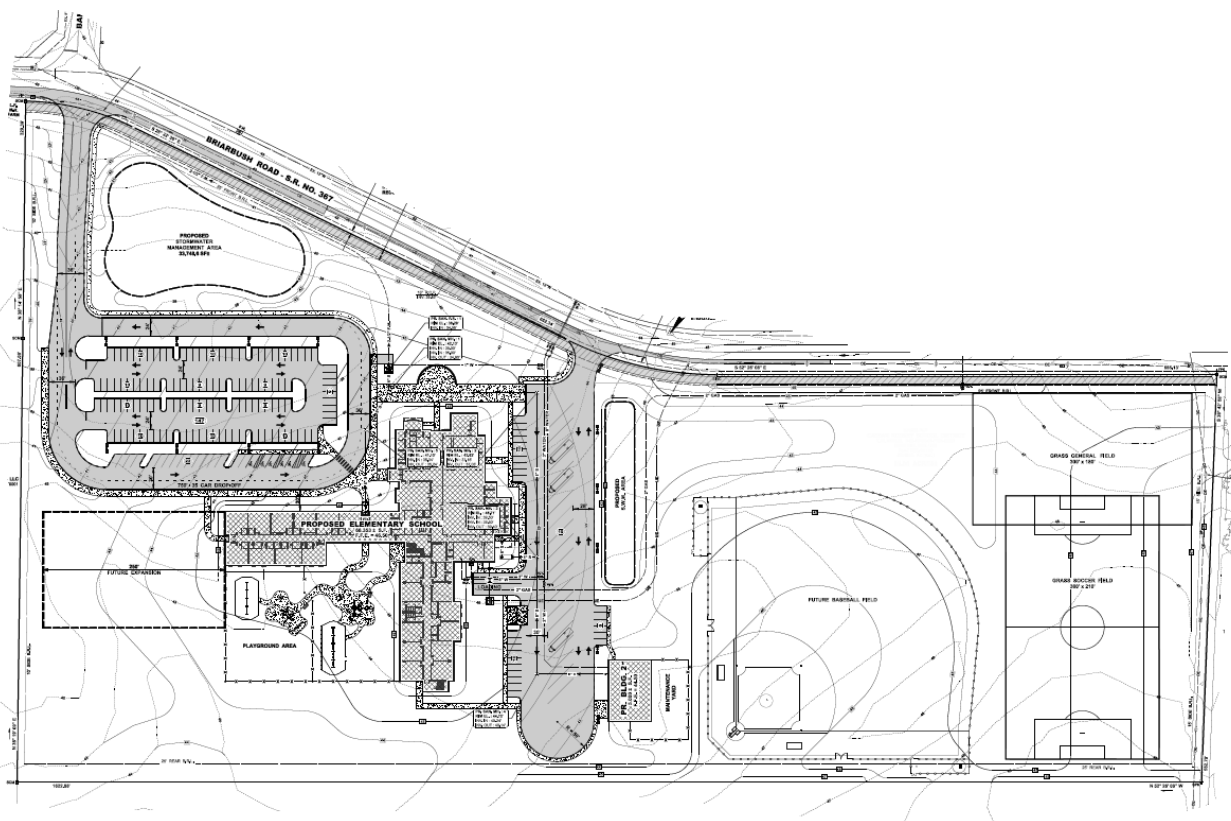

Exhibit B

Application: S-17-09
Caesar Rodney Elementary School

REQUEST SITE PLAN APPROVAL OF A PUBLIC ELEMENTARY SCHOOL LOCATED INSIDE THE GROWTH ZONE OVERLAY DISTRICT



PLOT PLAN (CROPPED)

Exhibit C

Application: S-17-09
Caesar Rodney Elementary School

REQUEST SITE PLAN APPROVAL OF A PUBLIC ELEMENTARY SCHOOL LOCATED INSIDE THE GROWTH ZONE OVERLAY DISTRICT



(full rendering attached to photo)



Building Rendering