

KENT COUNTY Board of Adjustment

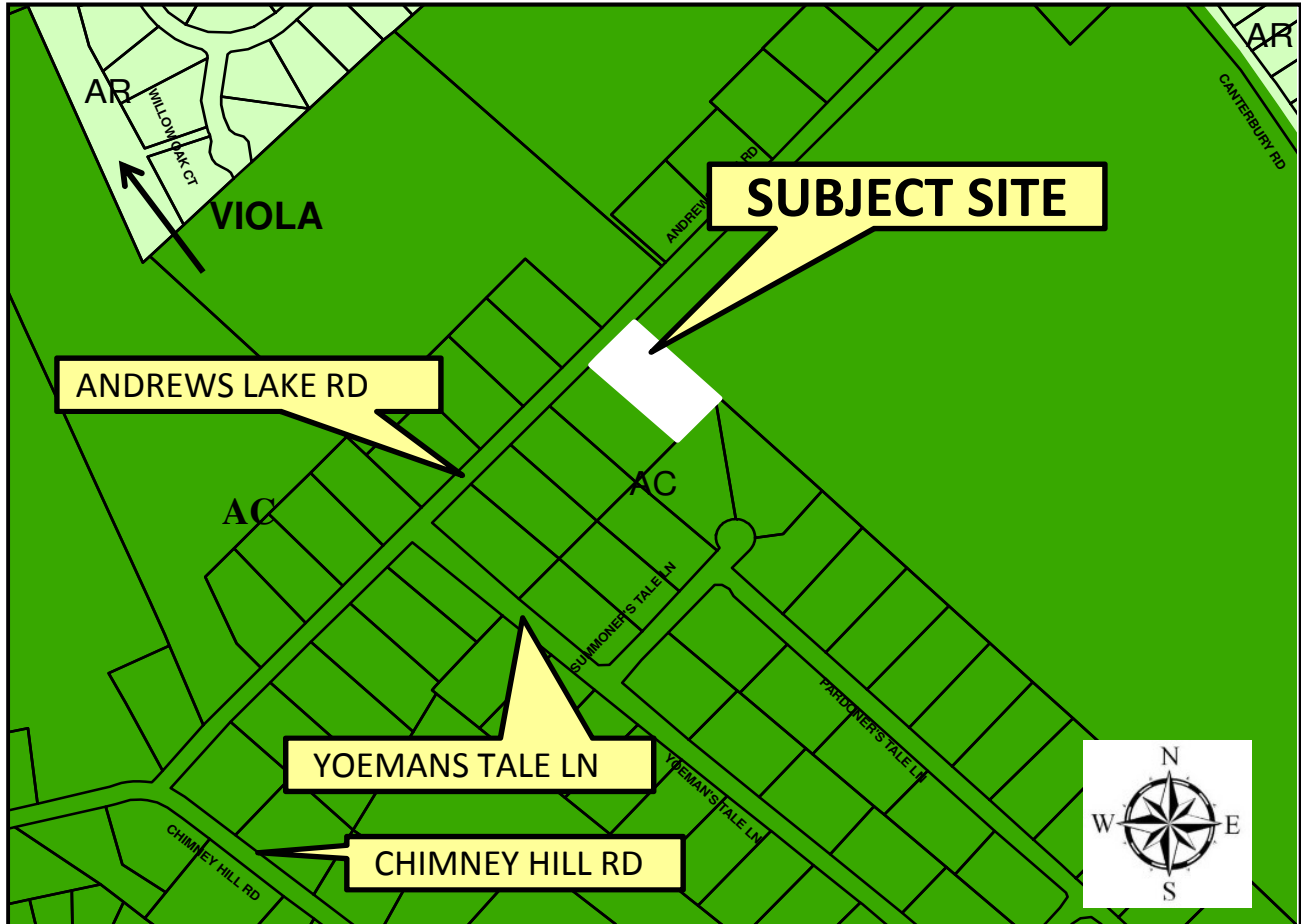

Exhibit A

Application: A-17-45
Block



LOCATION AND ZONING MAP

APPLICANTS/OWNERS: Arnold J. & Ceil Block

PRESENT ZONING DISTRICT: AC (Agricultural Conservation)

PROPOSED VARIANCE: Variance from provisions prohibiting an accessory structure to dominate in area the principal dwelling and the parking of a commercial vehicle on a residential lot

PRESENT USE: Residential

PROPOSED USE: Same, with accessory structure

LEVY COURT DISTRICT: 6th

TAX MAP NO: SM-00-129.00-02-20.12-000

LOCATION: Located on the southeast side of Andrews Lake Rd. (Co. Rd. 380), approx. 633' northeast of Yoemans Tale Ln., southeast of Viola.