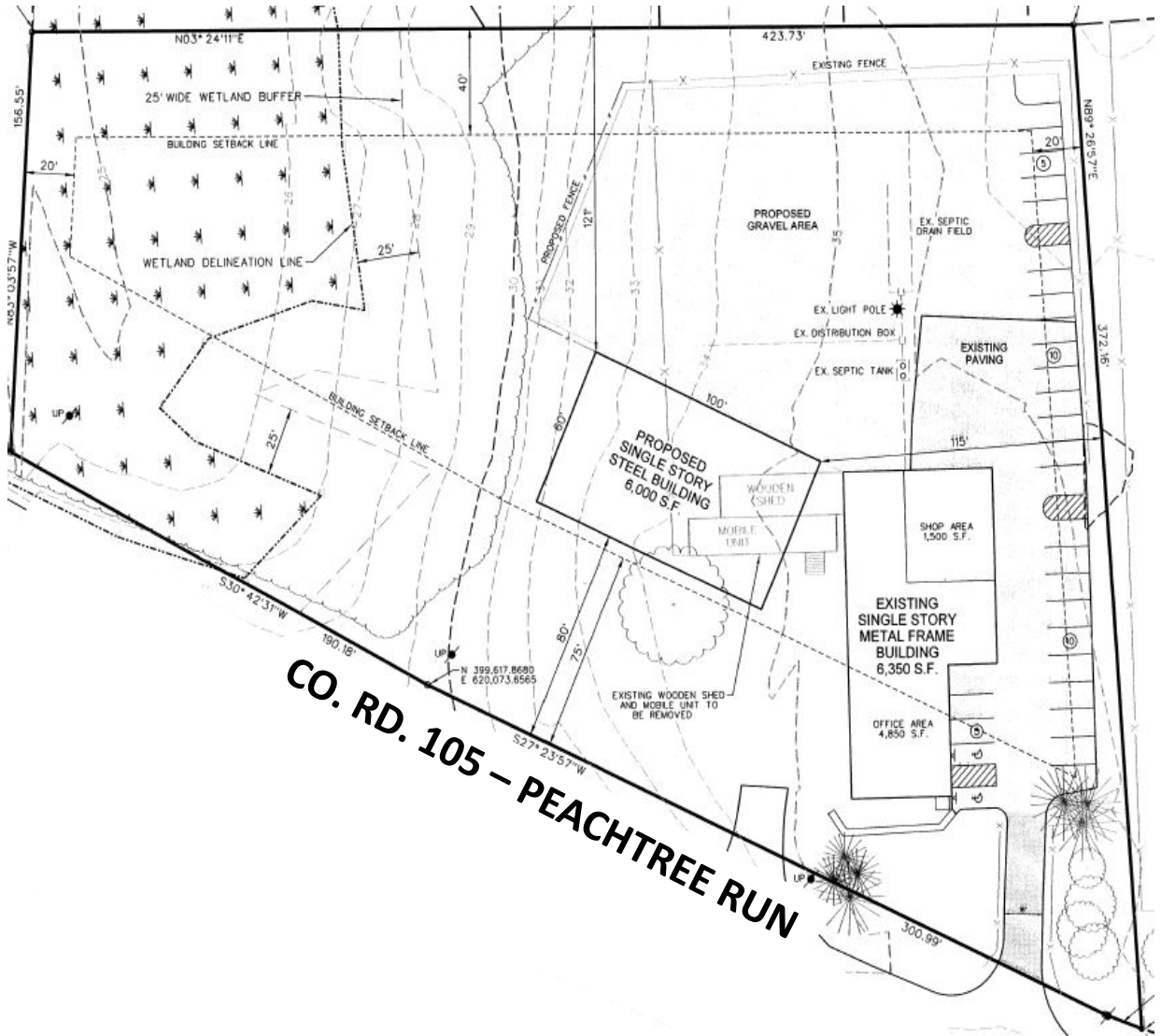

Exhibit B

Variance from the 15' planted screening requirement for the BG zoning district within the front setback area, from the condition prohibiting outdoor storage within a required setback area, and the condition requiring all outdoor storage to be screened from adjacent properties to enable a site plan application.



Variance from the 15' planted screening requirement for the BG zoning district within the front setback area, from the condition prohibiting outdoor storage within a required setback area, and the condition requiring all outdoor storage to be screened from adjacent properties to enable a site plan application.

SEABROOK VILLAGE SUBDIVISION

