

Kent County Levy Court

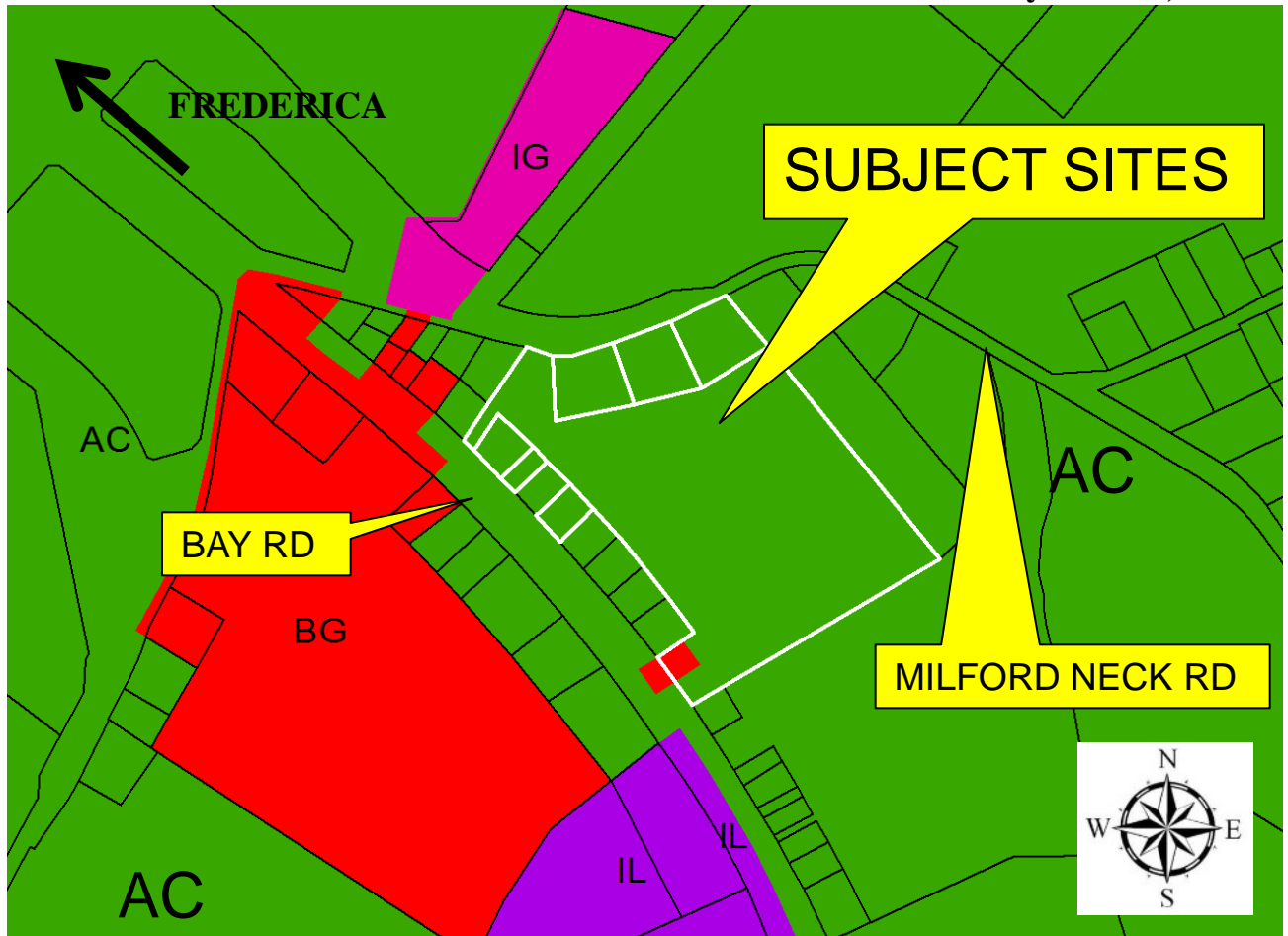

Exhibit A

Application: CZ-17-12
Kay-De Did, LLC



LOCATION AND ZONING MAP

APPLICANT: Kay-De Did, LLC
OWNERS: Kay-De Did, LLC
PRESENT COMPREHENSIVE PLAN DESIGNATION: Low Density Residential
PROPOSED COMPREHENSIVE DESIGNATION: Highway Commercial
PRESENT ZONING DISTRICT: AC (Agricultural Conservation)
PROPOSED ZONING DISTRICT: BG (General Business)
LEVY COURT DISTRICT: 4th
PRESENT USE: Agricultural/Residential
TAX MAP NO: MD-00-152.00-01-08.00-000, MD-00-152.00-01-09.00-000, MD-00-152.00-01-11.00-000, MD-00-152.00-01-66.00-000, MD-00-152.00-01-66.01-000, MD-00-152.00-01-66.02-000, MD-00-152.00-01-66.03-000
LOCATION: 25+/- acres on the east side of Bay Rd. (DE RT 1), and on the west side of Milford Neck Rd. (CO. RD. 120) southeast of Frederica

Kent County Levy Court



Application: CZ-17-12
Kay-De Did, LLC

Exhibit B

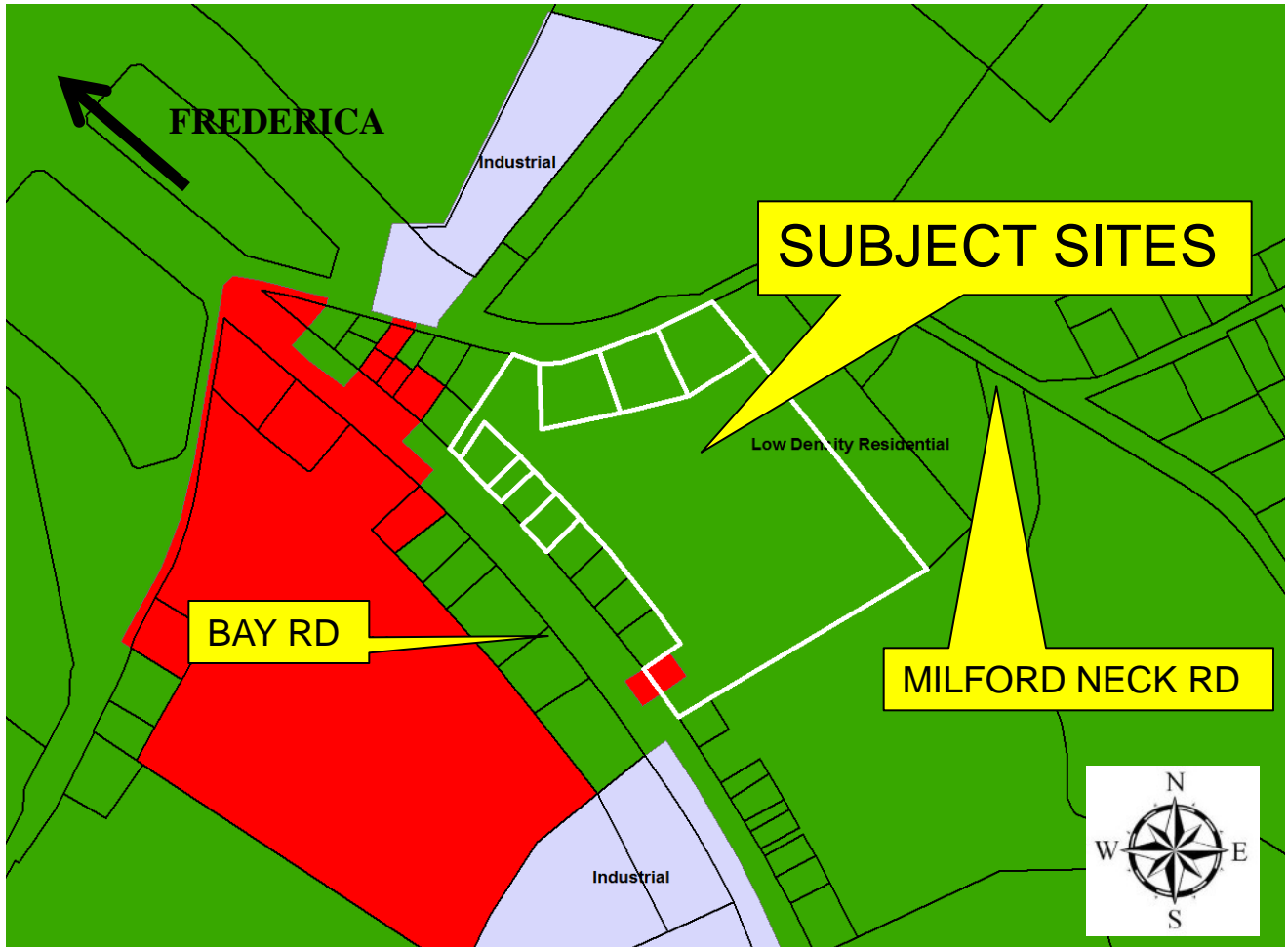

COMPREHENSIVE PLAN

APPLICANT: Kay-Dee Did, LLC

OWNERS: Kay-De Did, LLC

PRESENT COMPREHENSIVE PLAN DESIGNATION: Low Density Residential

PROPOSED COMPREHENSIVE DESIGNATION: Highway Commercial

PRESENT ZONING DISTRICT: AC (Agricultural Conservation)

PROPOSED ZONING DISTRICT: BG (General Business)

LEVY COURT DISTRICT: 4th

PRESENT USE: Agricultural/Residential

TAX MAP NO: MD-00-152.00-01-08.00-000, MD-00-152.00-01-09.00-000, MD-00-152.00-01-11.00-000, MD-00-152.00-01-66.00-000, MD-00-152.00-01-66.01-000, MD-00-152.00-01-66.02-000, MD-00-152.00-01-66.03-000

LOCATION: 25+/- acres on the east side of Bay Rd. (DE RT 1), and on the west side of Milford Neck Rd. (CO. RD. 120) southeast of Frederica

Exhibit C

Application: CZ-17-12
Kay-De Did, LLC

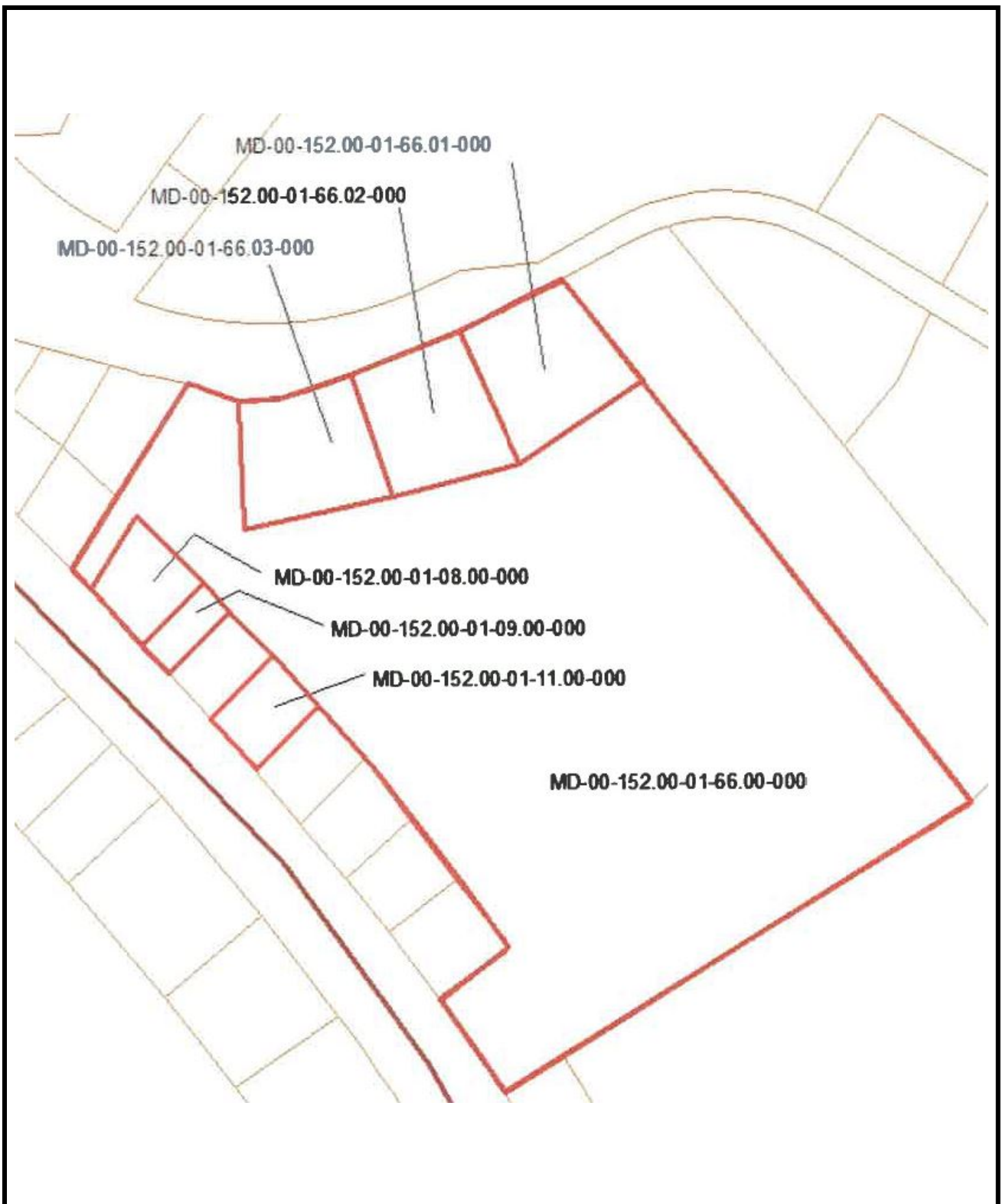

PLOT PLAN