

Kent County Levy Court

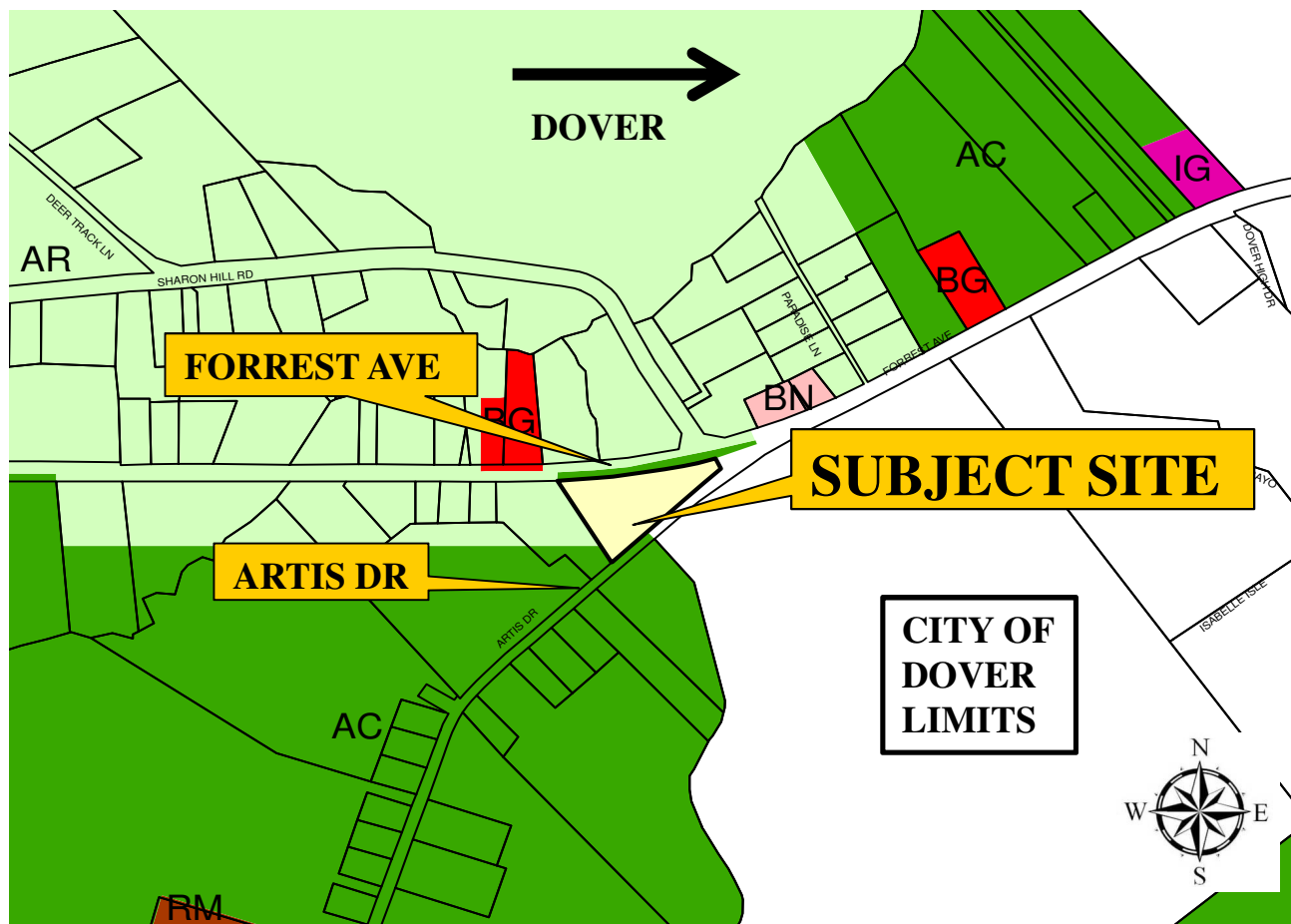

Exhibit A

Application: C-17-05
Thompson(Marks)



LOCATION AND ZONING MAP

APPLICANT: Shirley Thompson

OWNER: Mark Marks

PRESENT ZONING DISTRICT: AC (Agricultural Conservation)

PRESENT USE: Residential

PROPOSED USE: Same, with Home Occupation (*Life Consulting*)

LEVY COURT DISTRICT: 6th

TAX MAP NO: ED-00-075.02-01-31.00-000

LOCATION: 2.0 +/- acres on the southwest corner of Forrest Ave. (DE Rt. 8) and Artis Dr.

(Co. Rd. 197), west of Dover

Exhibit B

Application: C-17-05
Thompson(Marks)

PROPOSED HOME OCCUPATION (LIFE CONSULTANT)

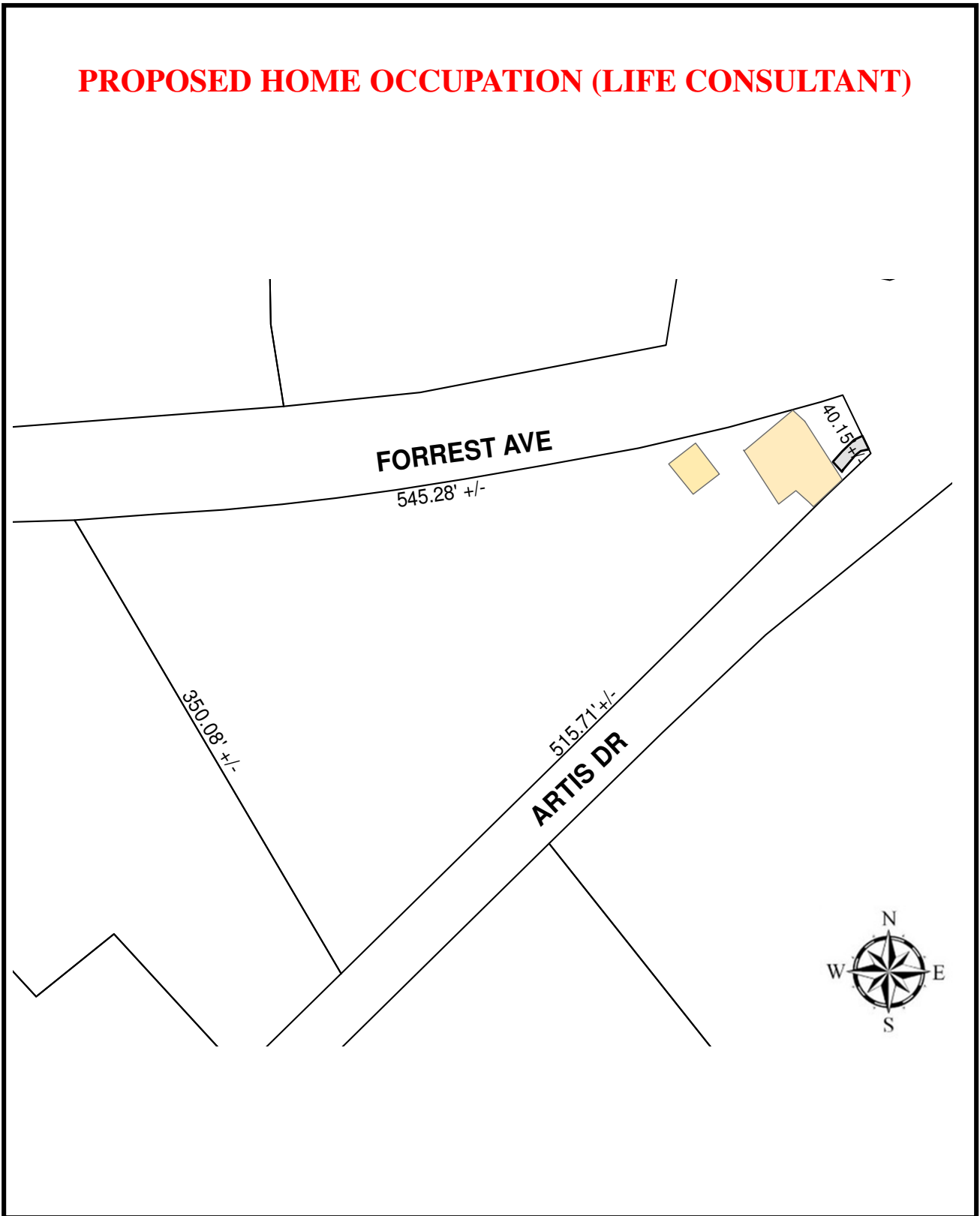

PLOT PLAN