

KENT COUNTY Board of Adjustment

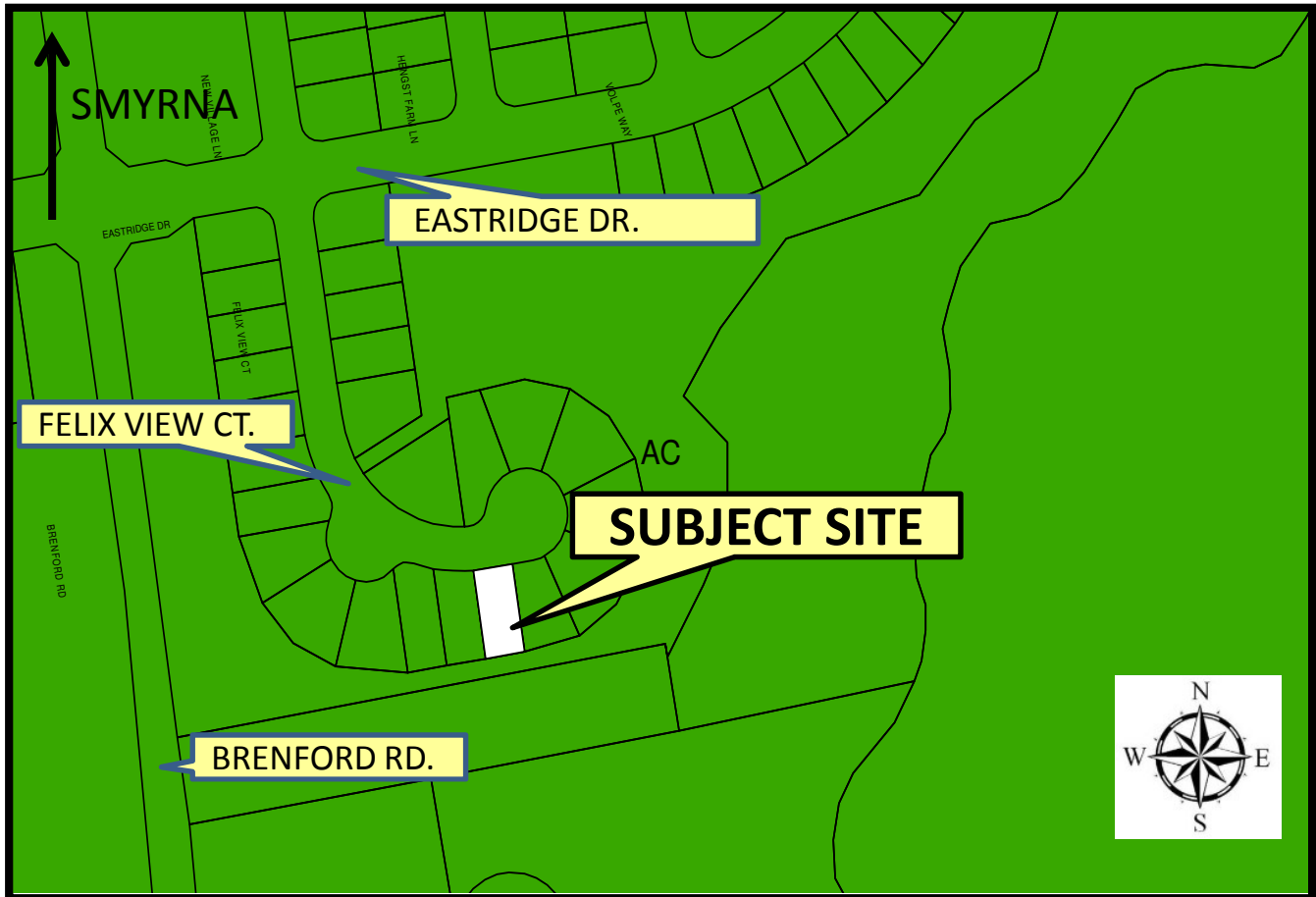

Exhibit A

Application: A-17-35
Hall



LOCATION AND ZONING MAP

APPLICANT: Gary Hall

OWNERS: Gary W. & Marie E. Hall

PRESENT ZONING DISTRICT: AC (Agricultural Conservation)

PROPOSED VARIANCE: Variance from the minimum required rear setback of 25 ft.

PRESENT USE: Residential

PROPOSED USE: Same, with porch addition

LEVY COURT DISTRICT: 1st

TAX MAP NUMBER: KH-00-036.02-05-83.00-000

LOCATION: Located on the south side of Felix View Ct. approx., 532' southeast of Eastridge Dr., being lot 67 of the Village of Eastridge subdivision, south of Smyrna