

KENT COUNTY Board of Adjustment

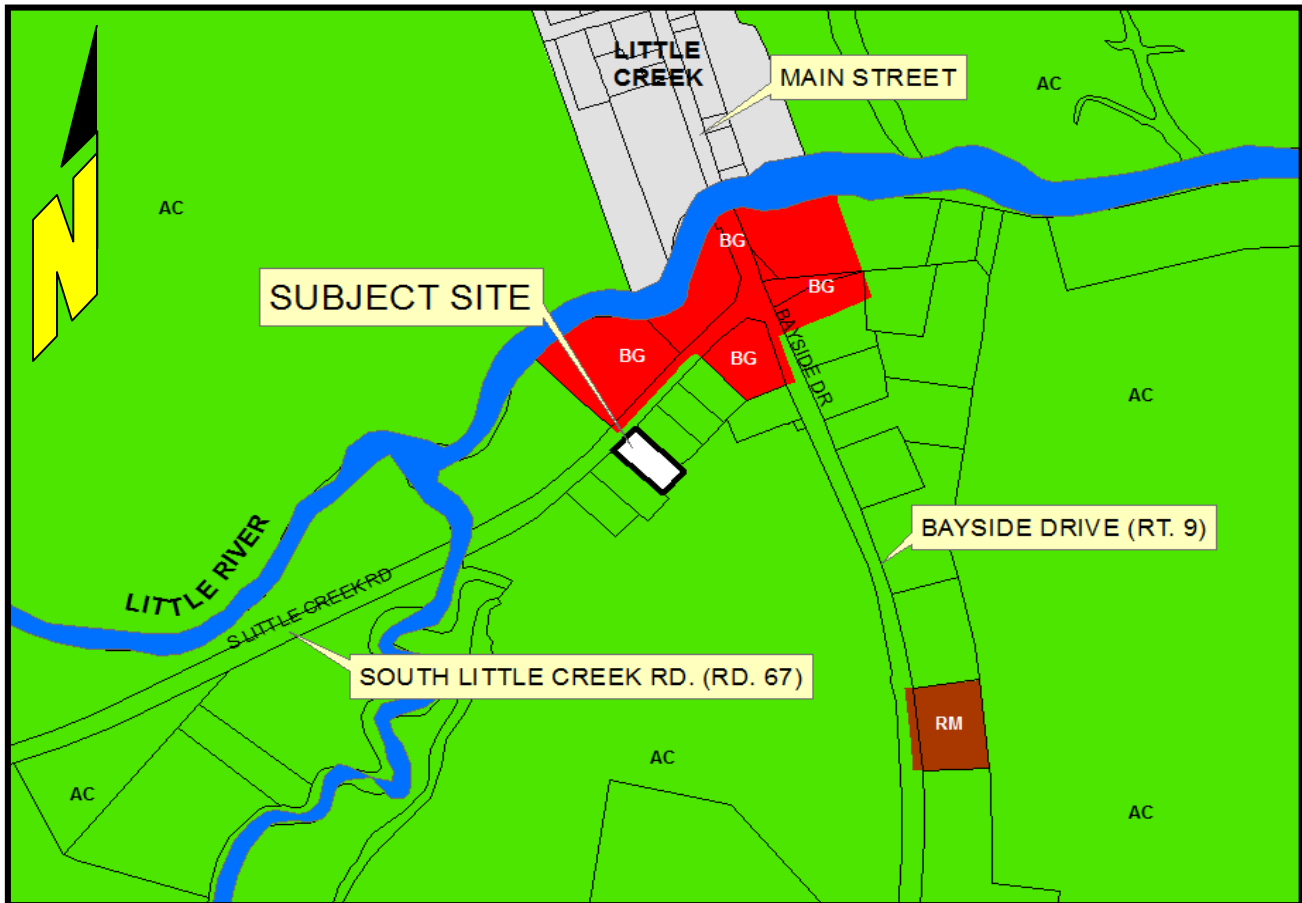

Exhibit A

Application: A-17-17
Mumford



LOCATION AND ZONING MAP

APPLICANT / OWNER: Dennis K. Mumford

PRESENT ZONING DISTRICT: AC (Agricultural Conservation)

PROPOSED VARIANCE: Variance from the maximum impervious surface coverage of 20%

PRESENT USE: Residential

PROPOSED USE: Same, with Accessory Structure

LEVY COURT DISTRICT: 3rd

TAX MAP NUMBER: ED-00-078.02-01-04.00-000

LOCATION: Located on the southeast sd. of South Little Creek Rd. (Co. Rd. 67), approx. 577' southwest of Bayside Drive, (DE. Rt. 9), south of Little Creek

Exhibit B

Application: A-17-17
Mumford

Variance from the maximum impervious surface coverage of 20% to enable an accessory structure

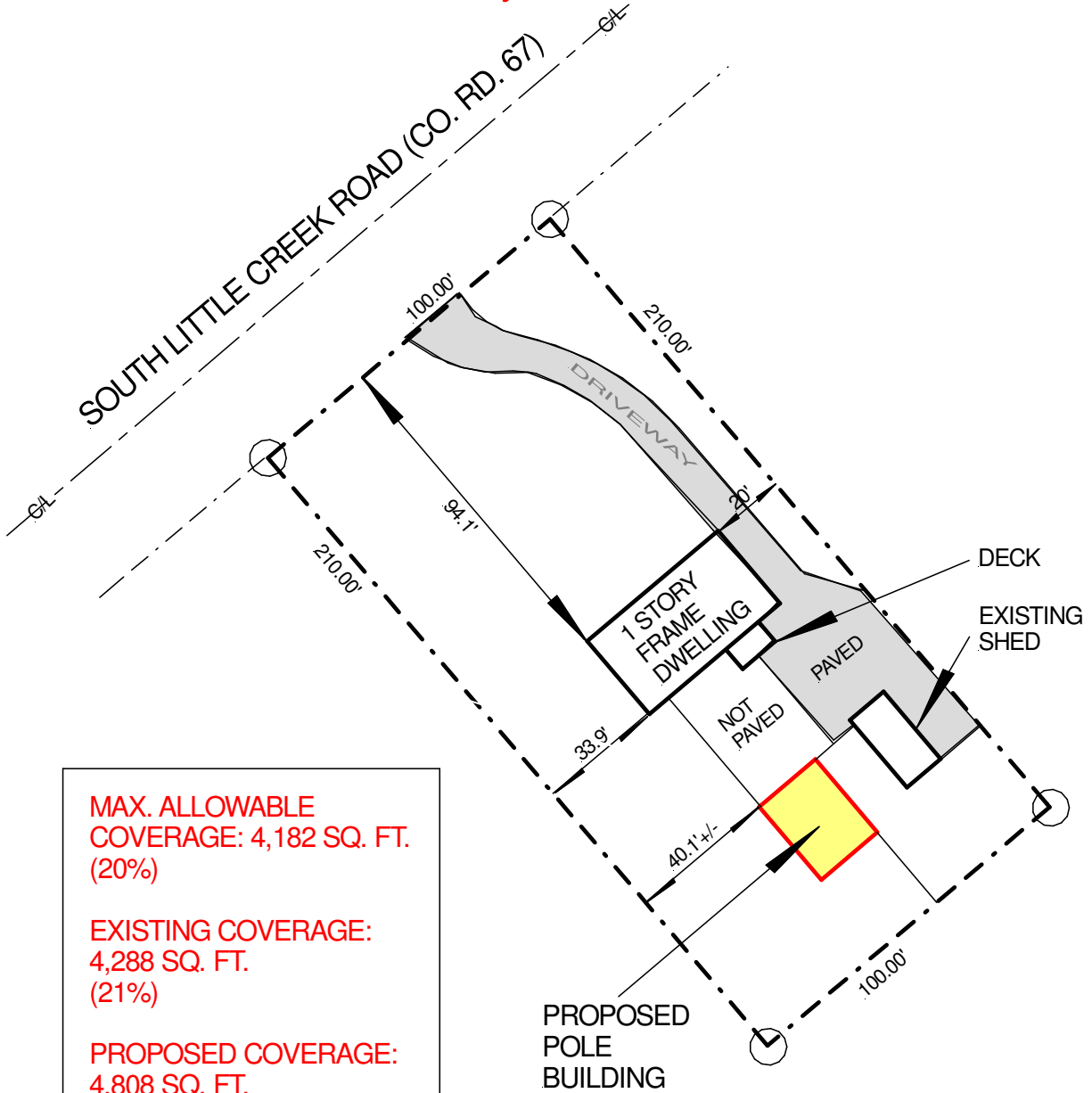

**MAX. ALLOWABLE
COVERAGE: 4,182 SQ. FT.
(20%)**

**EXISTING COVERAGE:
4,288 SQ. FT.
(21%)**

**PROPOSED COVERAGE:
4,808 SQ. FT.
(23%)**

**LOT SIZE:
0.48+/- ACRES
(20,909 SQ. FT.)**