

KENT COUNTY Board of Adjustment

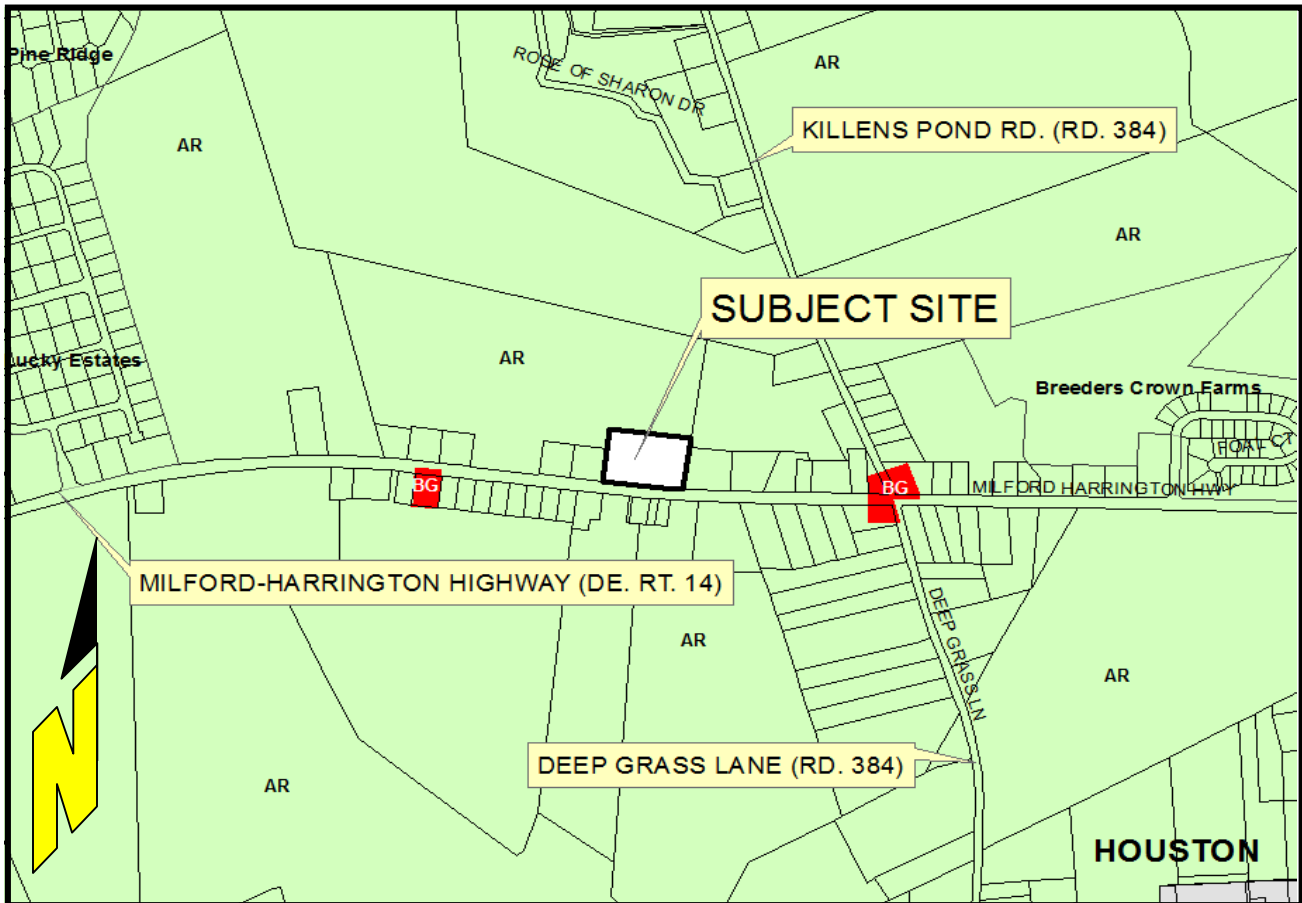

Exhibit A

Application: A-17-15
Pilgrim Chapel



LOCATION AND ZONING MAP

APPLICANT / OWNER: Pilgrim Chapel

PRESENT ZONING DISTRICT: AR (Agricultural Residential)

PROPOSED VARIANCE: Variance from the maximum number of detached signs

PRESENT USE: Church

PROPOSED USE: Same, with two detached signs

LEVY COURT DISTRICT: 4th

TAX MAP NUMBER: MN-00-172.00-01-13.01-000

LOCATION: Located on the north sd. of Milford-Harrington Highway (DE. Rt. 14), approx. 1,299' from Killens Pond Rd. (Co. Rd. 384), northwest of Houston

Exhibit B

Application: A-17-15
Pilgrim Chapel

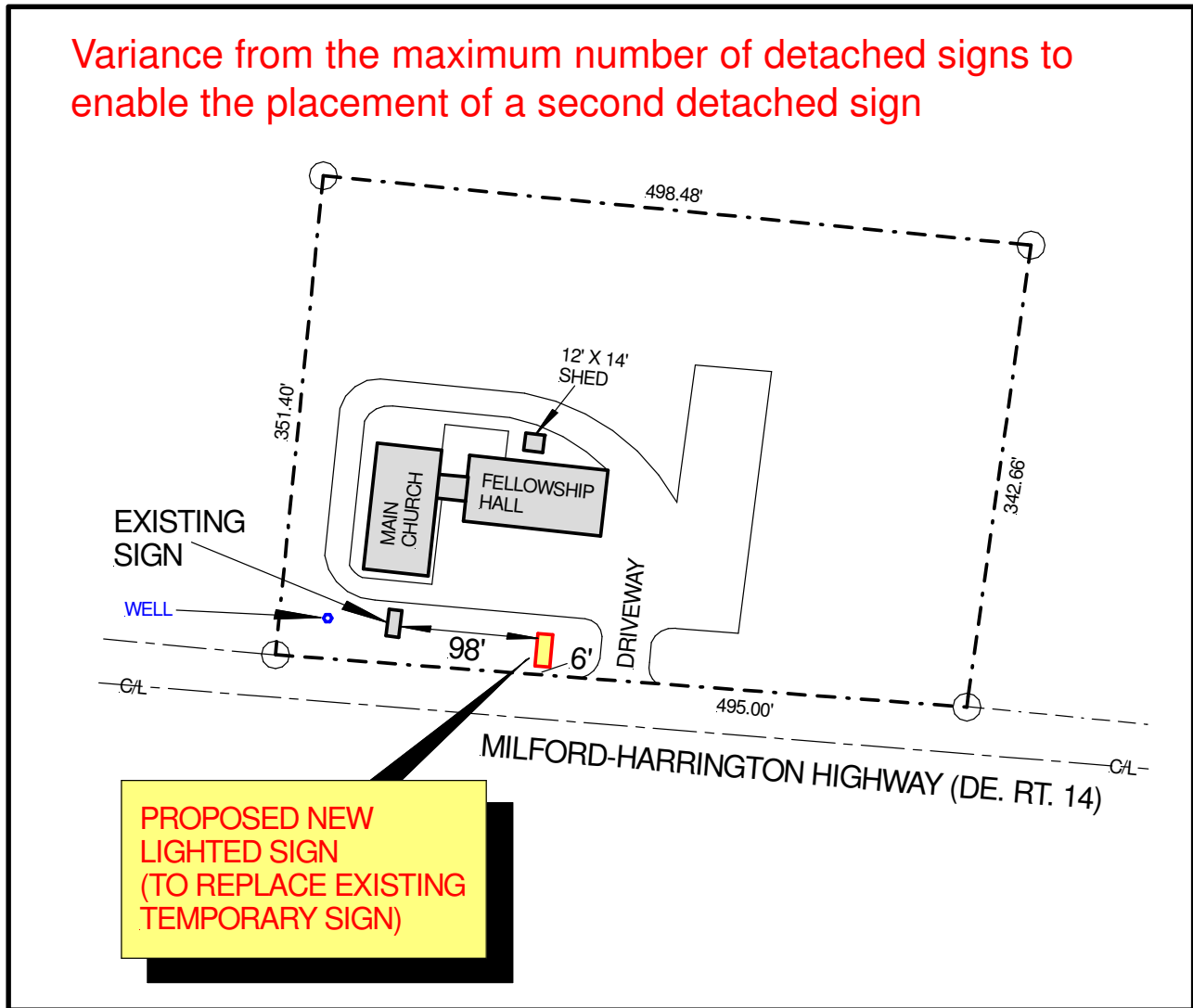

PLOT PLAN

APPLICANT / OWNER: Pilgrim Chapel

PRESENT ZONING DISTRICT: AR (Agricultural Residential)

PROPOSED VARIANCE: Variance from the maximum number of detached signs

PRESENT USE: Church

PROPOSED USE: Same, with two detached signs

LEVY COURT DISTRICT: 4th

TAX MAP NUMBER: MN-00-172.00-01-13.01-000

LOCATION: Located on the north sd. of Milford-Harrington Highway (DE. Rt. 14), approx.

1,299' from Killens Pond Rd. (Co. Rd. 384), northwest of Houston

Exhibit C

Application: A-17-15
Pilgrim Chapel

Variance from the maximum number of detached signs to enable the placement of a second detached sign 4' high by 8' wide

