

# KENT COUNTY

## Board of Adjustment



### Exhibit A

Application: A-17-17  
Mumford

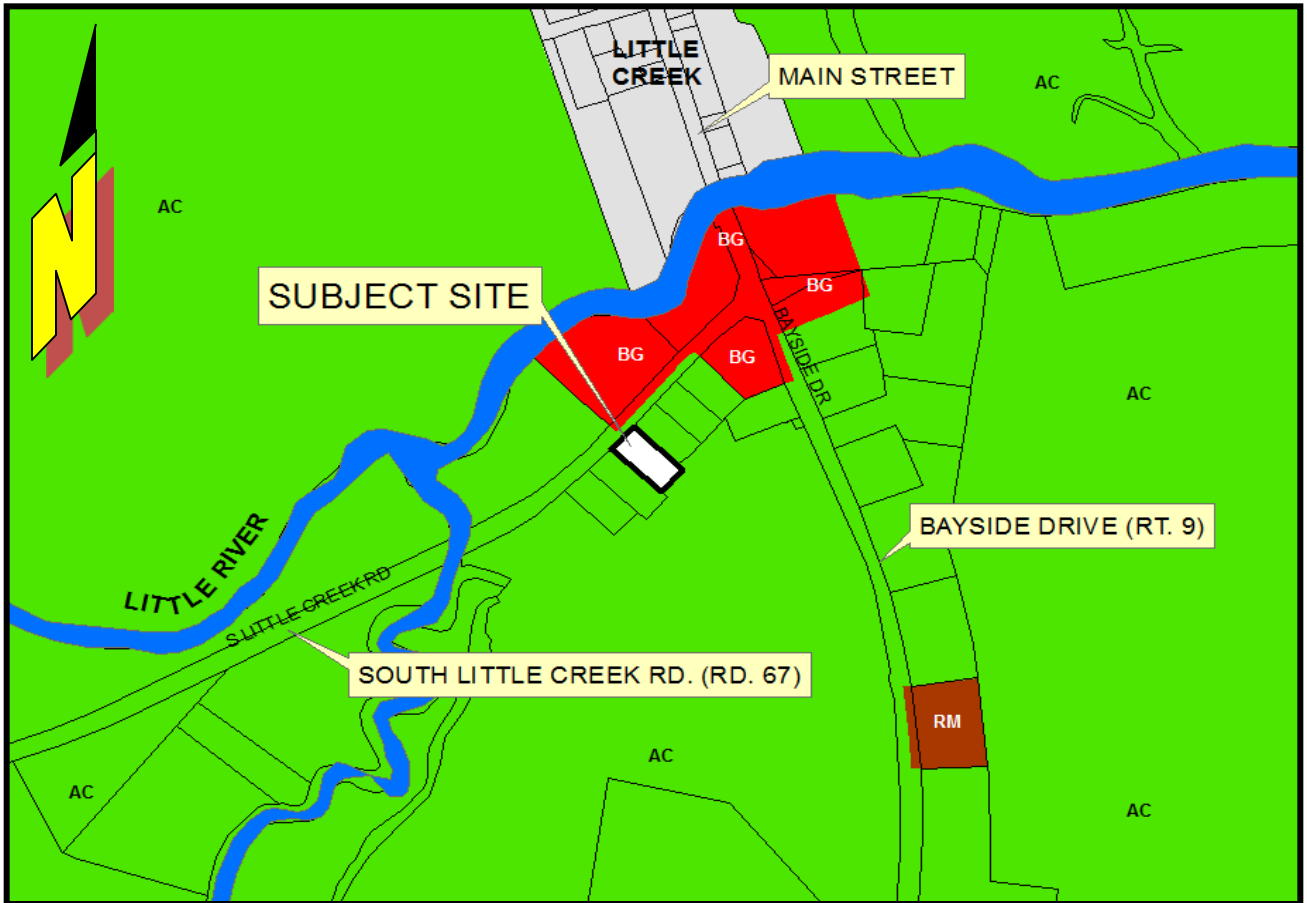

## LOCATION AND ZONING MAP

APPLICANT / OWNER: Dennis K. Mumford

PRESENT ZONING DISTRICT: AC (Agricultural Conservation)

PROPOSED VARIANCE: Variance from the maximum impervious surface coverage of 20%

PRESENT USE: Residential

PROPOSED USE: Same, with Accessory Structure

LEVY COURT DISTRICT: 3rd

TAX MAP NUMBER: ED-00-078.02-01-04.00-000

LOCATION: Located on the southeast sd. of South Little Creek Rd. (Co. Rd. 67), approx. 577' southwest of Bayside Drive, (DE. Rt. 9), south of Little Creek

Variance from the maximum impervious surface coverage of 20% to enable an accessory structure

