

GENERAL LANDSCAPE NOTES

- QUALITY AND SIZE OF PLANTS, SPREAD OF ROOTS, AND SIZE OF ROOT BALLS SHALL BE IN ACCORDANCE WITH THE CURRENT STANDARDS OF THE AMERICAN ASSOCIATION OF NURSERYMEN "AMERICAN STANDARDS FOR NURSERY STOCK".
- CONTRACTOR SHALL BE REQUIRED TO GUARANTEE ALL PLANT MATERIALS FOR A PERIOD OF ONE YEAR AFTER INSTALLATION IS COMPLETE AND FINAL ACCEPTANCE OF PHASE I SITE WORK HAS BEEN GIVEN. AT THE END OF ONE YEAR ALL PLANT MATERIAL WHICH IS DEAD OR DYING SHALL BE REPLACED AT THE CONTRACTOR'S EXPENSE AS ORIGINALLY SPECIFIED.
- CONTRACTOR SHALL BE RESPONSIBLE FOR ANY DAMAGE TO UTILITIES AND MAY MAKE MINOR ADJUSTMENTS IN SPACING AND/OR LOCATION OF PLANT MATERIALS. CONTRACTOR TO VERIFY "AS BUILT" LOCATION OF ALL UTILITIES.
- NO SUBSTITUTIONS SHALL BE MADE WITHOUT APPROVAL OF THE OWNER.
- ALL AREAS NOT STABILIZED IN PAVING OR PLANT MATERIALS SHOULD BE SEEDED AND MULCHED. (SEE EROSION & SEDIMENT CONTROL PLAN.)
- EVERGREEN TREES SHALL HAVE A FULL, WELL-BRANCHED, CONICAL FORM TYPICAL OF THE SPECIES.
- ALL DECIDUOUS SHADE TREES SHALL BRANCH A MINIMUM OF 7'-0" ABOVE GROUND LEVEL. TREES SHALL BE PLANTED AND STAKED IN ACCORDANCE WITH THE STAKING DETAIL SHOWN.
- THE FULL EXTENT OF ALL PLANTING BEDS SHALL RECEIVE 4" OF TOPSOIL AND 3" OF SHREDDED HARDWOOD MULCH PER SPECIFICATIONS.
- THE CONTRACTOR SHALL SUPPLY ALL PLANT MATERIALS IN QUANTITIES SUFFICIENT TO COMPLETE THE PLANTINGS SHOWN ON THIS DRAWING AND AS SPECIFIED.
- ALL PLANTS SHALL BEAR THE SAME RELATIONSHIP TO FINISHED GRADE AS THE PLANT'S ORIGINAL GRADE BEFORE DIGGING.
- THE CONTRACTOR SHALL WATER ALL PLANTS THOROUGHLY TWICE DURING THE FIRST 24-HOUR PERIOD AFTER PLANTING, AND THEN WEEKLY OR MORE OFTEN, IF NECESSARY, DURING THE FIRST GROWING SEASON.

LANDSCAPE PLANT SCHEDULE					
SYMBOL	KEY	BOTANICAL NAME	COMMON NAME	SIZE	QUANTITY
DECIDUOUS TREE					
AC	Amelanchier canadensis	SERVICEBERRY	5'/6" Ht., B&B	9	
CC	Cercis canadensis	EASTERN REDBUD	5'/6" Ht., B&B	3	
CV	Chionanthus virginicus	FRINGETREE	5'/6" Ht., B&B	3	
GT	Gleditsia triacanthos "Shademaster"	HONEY LOCUST	1 3/4"-2" Cal./, B&B	3	
EVERGREEN TREE					
IE	Ilex x "Emily Bruner"	Emily Bruner Holly	5'/6" Ht., B&B	3	
EVERGREEN SHRUB					
ND	Nandina domestica "Firepower"	"FIREPOWER" NANDINA	15-18", Cont.	40	
RR	Rosa "RADTKO"	DOUBLE KNOCKOUT ROSE	15-18", Cont.	18	
JP	Juniperus chinensis "PFITERIANA COMPACTA"	COMPACT PFITZER JUNIPER	2-3" Ht., B&B	54	

LEGEND

PROPOSED

- PAVEMENT / FULL DEPTH
- SIDEWALK
- CONCRETE PAD
- PARKING COUNT IDENTIFICATION
- CONTOUR ELEVATION AND LABEL
- AUTO DEALERSHIP BUILDING
- P.C.C. CURB TYPE 1-8

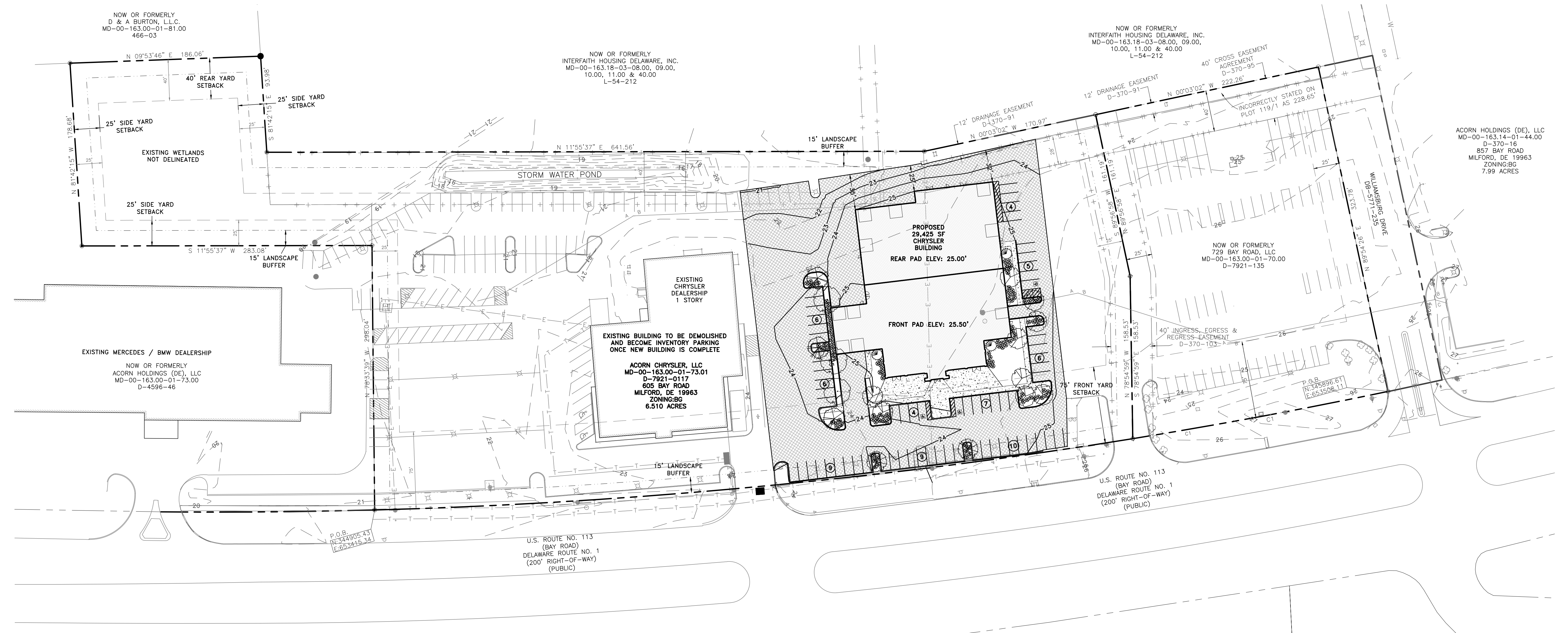
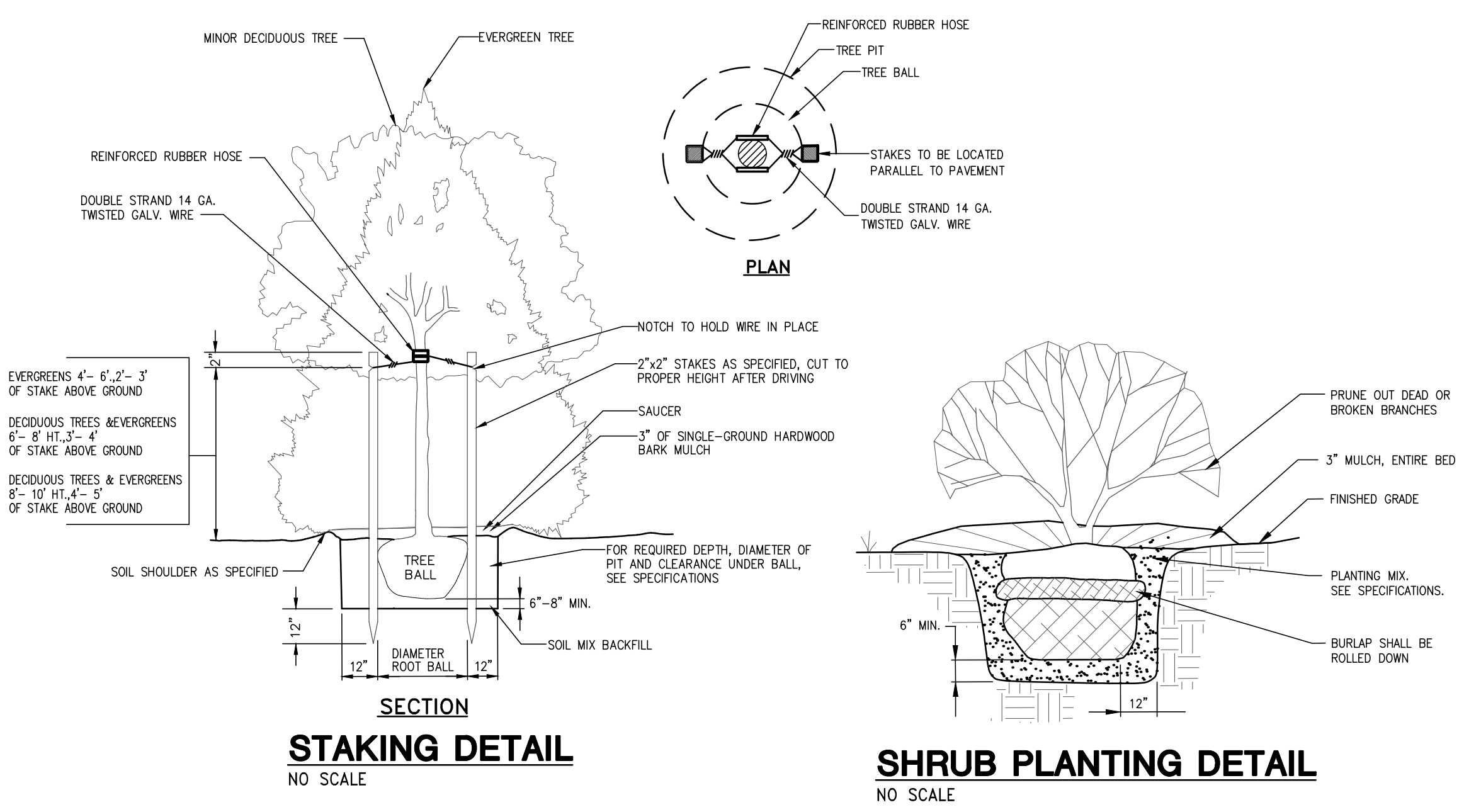

CURVE TABLE

CURVE	RADIUS	ARC LENGTH	CHORD LENGTH	CHORD BEARING	DELTA ANGLE
C1	5598.58'	743.60'	743.05'	S 06°38'34" W	07°33'36"



I.G. BURTON NEW CHRYSLER BUILDING
MILFORD HUNDRED
KENT COUNTY, DELAWARE

Date: JANUARY 2017
Scale: 1"=50'
Dwn.By: ACM
Proj.No.: 0608C001
Dwg.No.:

PL-2